

# IGNITION SWITCH

## COMPONENTS

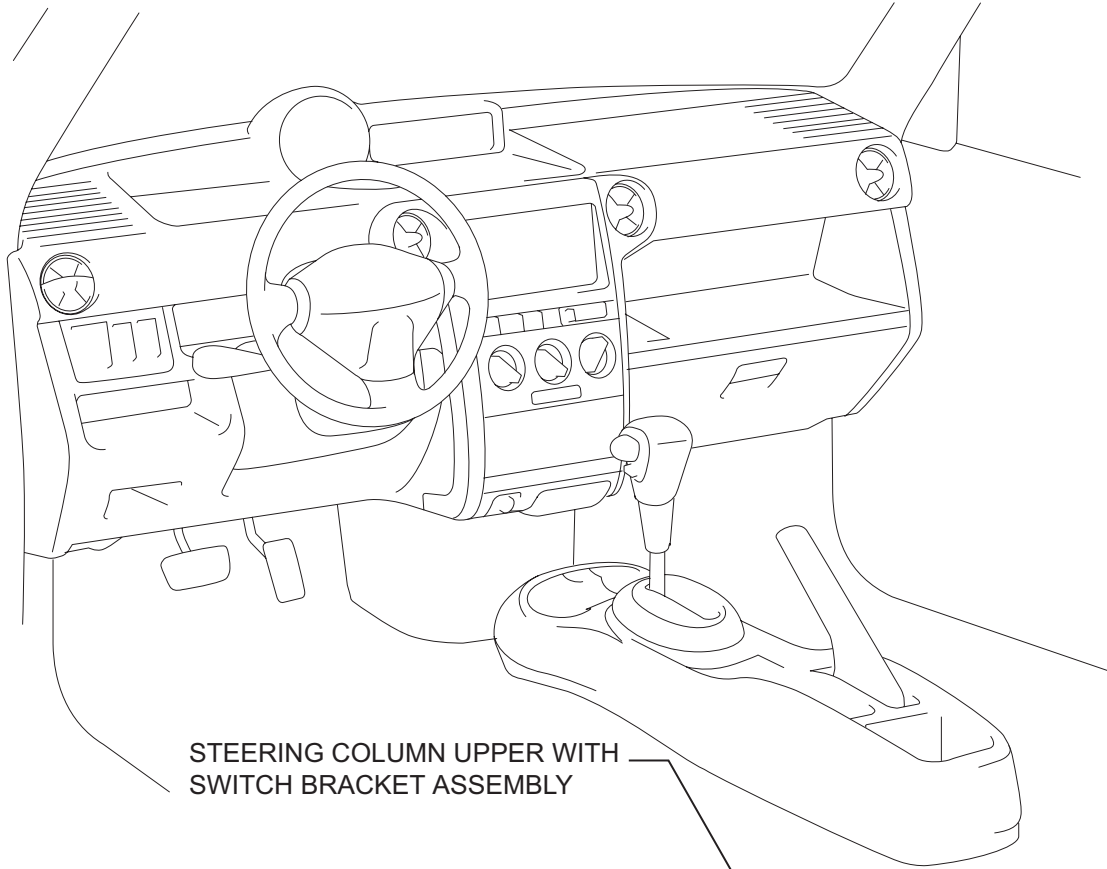

STEERING COLUMN UPPER WITH SWITCH BRACKET ASSEMBLY

● STEERING LOCK SET BOLT

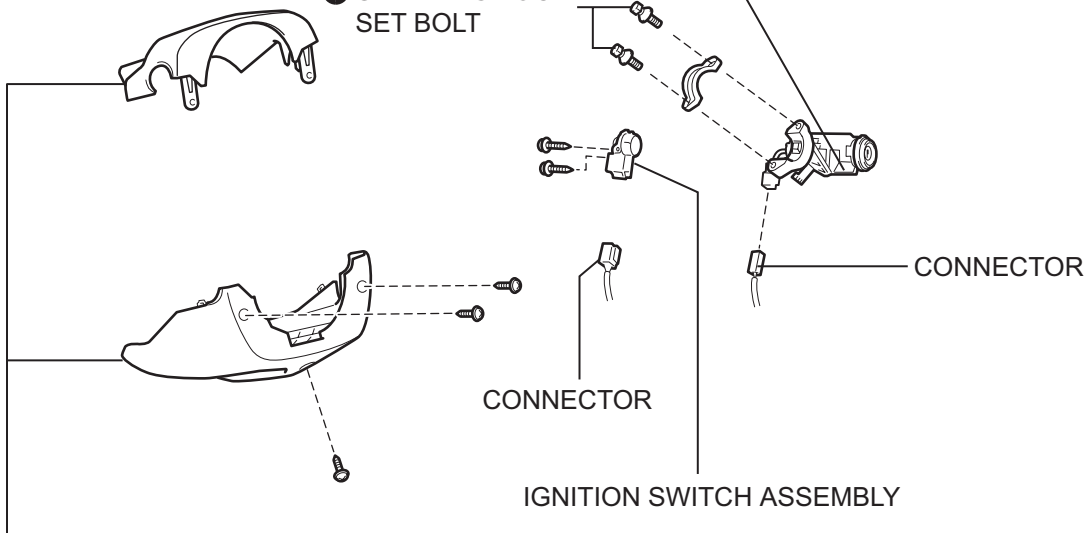

STEERING COLUMN COVER

CONNECTOR

IGNITION SWITCH ASSEMBLY

CONNECTOR

● Non-reusable part

ST

T

## REMOVAL

1. **DISCONNECT CABLE FROM NEGATIVE BATTERY TERMINAL**

**CAUTION:**

Wait at least 90 seconds after disconnecting the cable from the negative (-) battery terminal to prevent airbag and seat belt pretensioner activation.

2. **REMOVE STEERING COLUMN COVER**

- (a) Remove the 3 screws, cover lower and upper.

**HINT:**

Turn the steering wheel to the right and left as necessary to remove the 3 screws and cover lower.

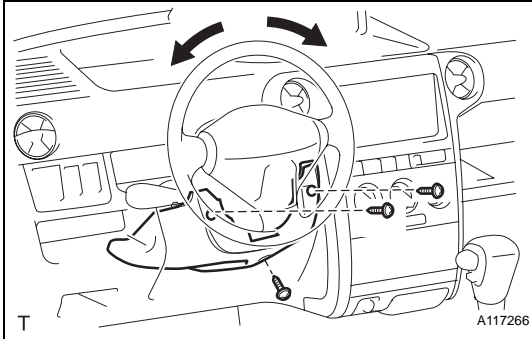

3. **DISCONNECT CONNECTOR**

- (a) Disconnect the 2 connectors and wire harness clamps from the steering column.

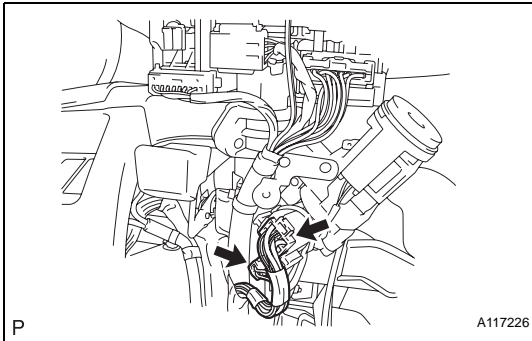

4. **REMOVE STEERING COLUMN UPPER WITH SWITCH BRACKET ASSEMBLY**

- (a) Using a centering punch, mark the center of the 2 tapered-head bolts.
- (b) Using a 3 to 4 mm (0.12 to 0.16 in.) drill, drill a hole in the 2 bolt heads.
- (c) Using a screw extractor, remove the 2 bolts, clamp and steering column upper with switch bracket.

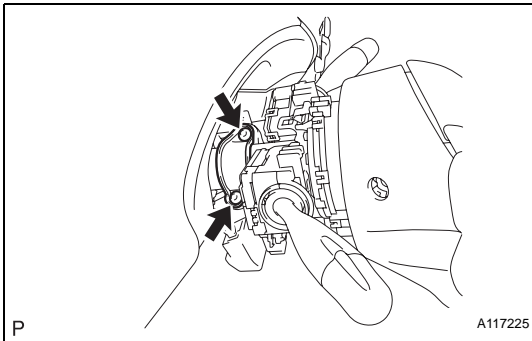

5. **REMOVE IGNITION SWITCH ASSEMBLY**

- (a) Remove the 2 screws and switch from the steering column bracket.

