

INSPECTION

1. INSPECT IGNITION SWITCH ASSEMBLY

- (a) Measure the resistance of the switch.

Standard resistance

Tester Connection	Switch Condition	Specified Condition
Between all terminals	LOCK	10 k Ω or higher
1 (AM1) - 3 (ACC)	ACC	Below 1 Ω
1 (AM1) - 2 (IG1) 1 (AM1) - 3 (ACC) 5 (AM2) - 6 (IG2)	ON	Below 1 Ω
1 (AM1) - 2 (IG1) 4 (ST2) - 5 (AM2) 5 (AM2) - 6 (IG2)	START	Below 1 Ω

If the result is not as specified, replace the ignition switch assembly.

INSTALLATION

1. INSTALL IGNITION SWITCH ASSEMBLY

- (a) Install the switch to the steering column bracket with the 2 screws.

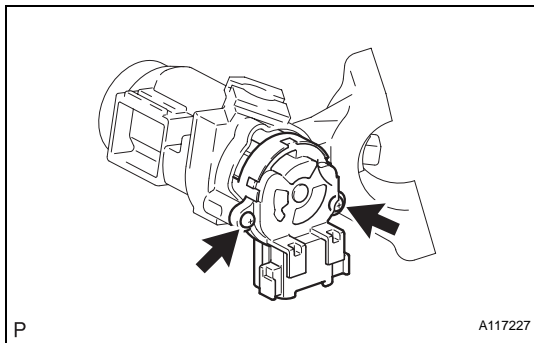

2. REMOVE STEERING COLUMN UPPER WITH SWITCH BRACKET ASSEMBLY

- (a) Temporarily install the steering column upper with switch bracket and steering column clamp upper with 2 new steering lock set bolts.
- (b) Tighten the 2 steering lock set bolts until the bolt heads break off.

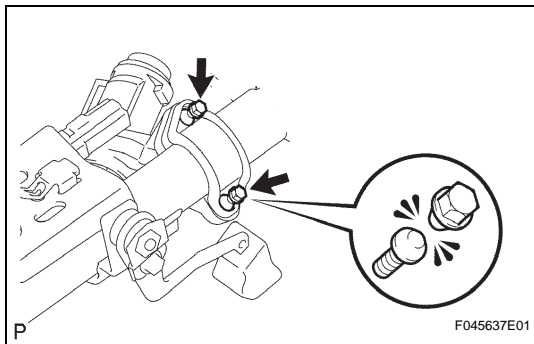

3. CONNECT CONNECTOR

- (a) Connect the 2 connectors as shown in the illustration.
- (b) Secure the wire harness with the clamps.

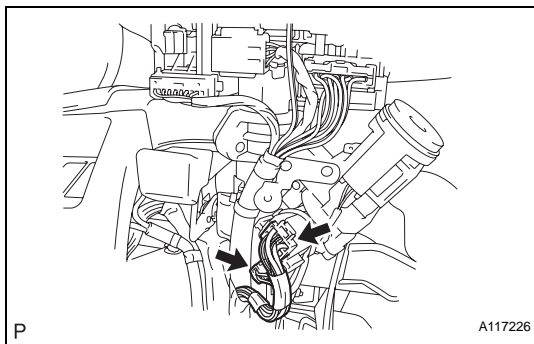

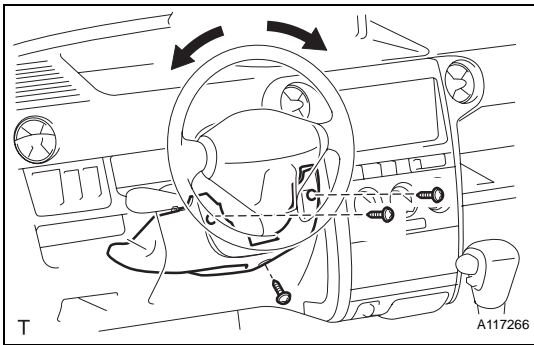
**4. INSTALL STEERING COLUMN COVER**

(a) Install the cover lower and upper with the 3 screws.

HINT:

Turn the steering wheel to the right and left as necessary to install the 3 screws and cover lower.

5. CONNECT CABLE TO NEGATIVE BATTERY TERMINAL