

INSPECTION

1. INSPECT STARTER ASSEMBLY

NOTICE:

These tests must be performed within 3 to 5 seconds to prevent the coil from burning out.

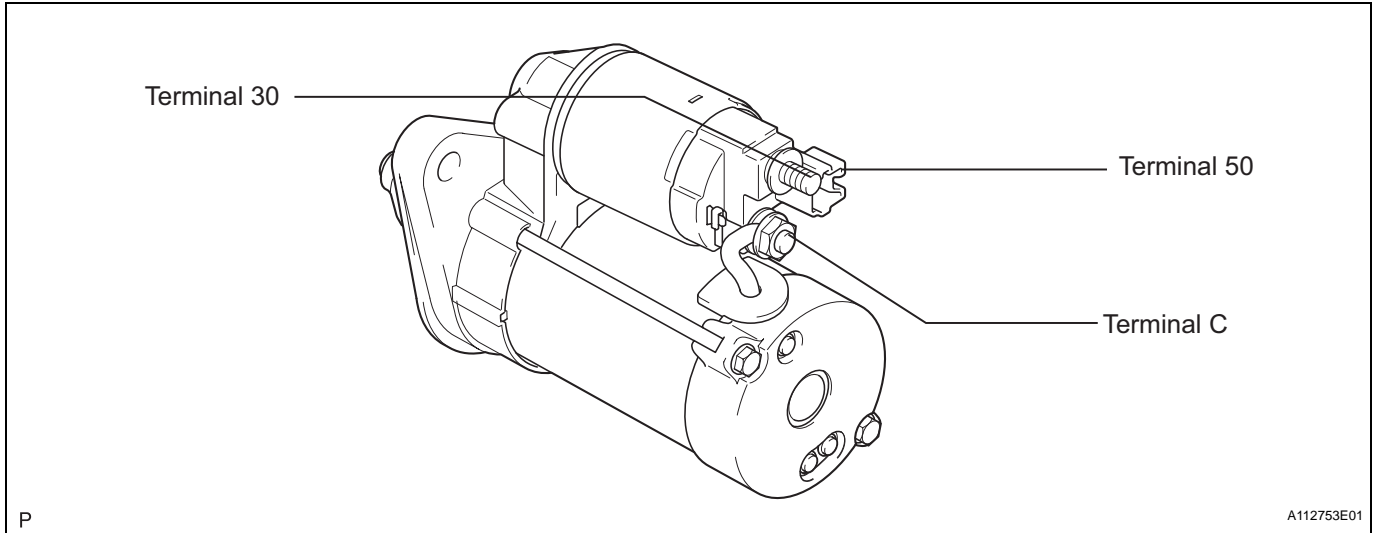

(a) Perform pull-in/holding test.

- (1) Disconnect the field coil lead wire from terminal C.
- (2) Connect the battery to the magnet switch as shown in the illustration. Then check that the clutch pinion gear moves outward.

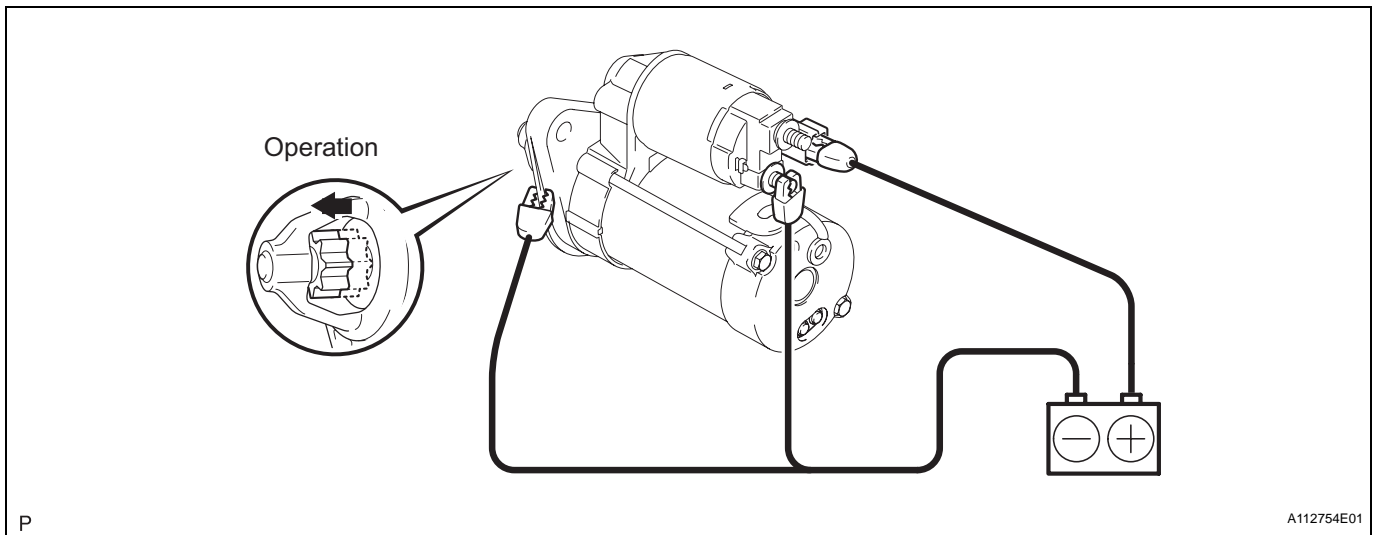

- (3) Disconnect the negative (-) lead from terminal C. Check that the pinion gear remains out.

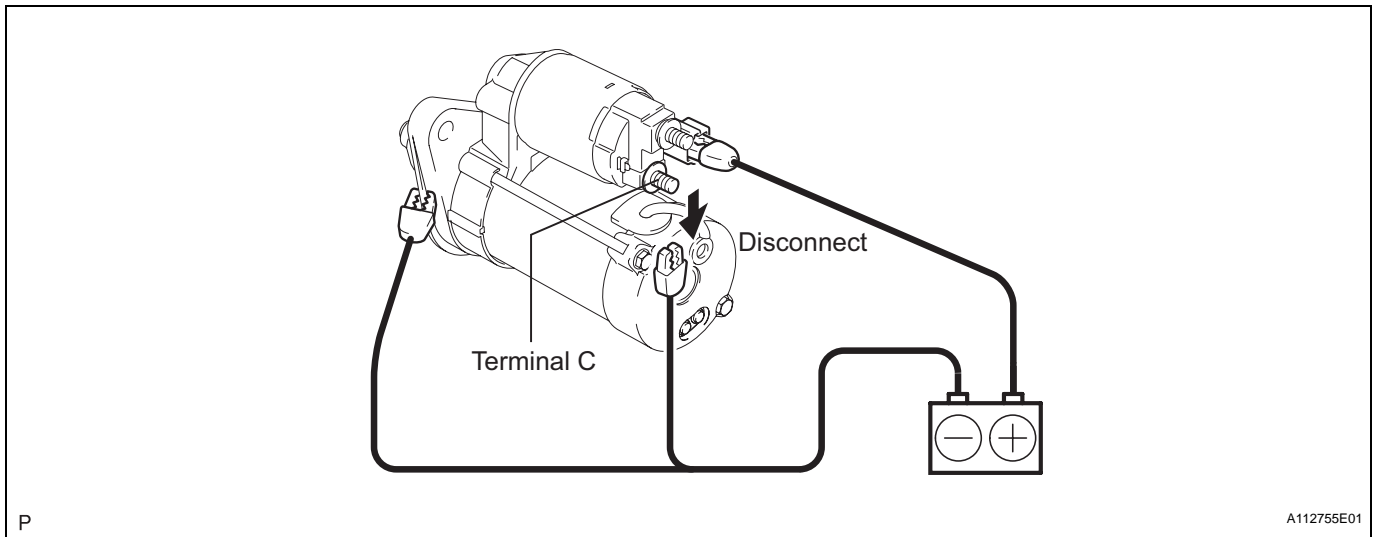

- (4) Disconnect the negative (-) lead from the starter body. Check that the clutch pinion gear returns inward.

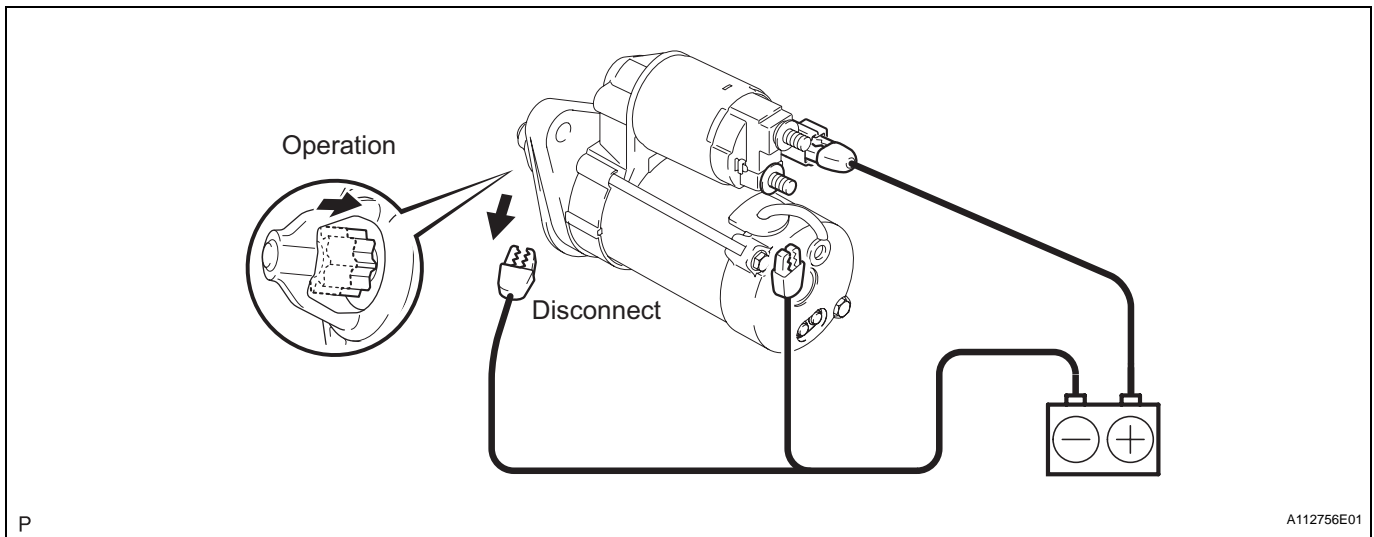

If the result is not as specified, replace the magnet switch body.

- (b) Perform operation test without load.
- (1) Connect the field coil lead wire to terminal C.
Torque: 5.9 N*m (60 kgf*cm, 52 in.*lbf)
 - (2) Grip the starter with a vise.
 - (3) Connect the battery and ammeter to the starter as shown in the illustration.
 - (4) Check that the starter rotates smoothly and steadily while the pinion gear is moving outward. Then measure the current.
Standard current:
90 A or less at 11.5 V

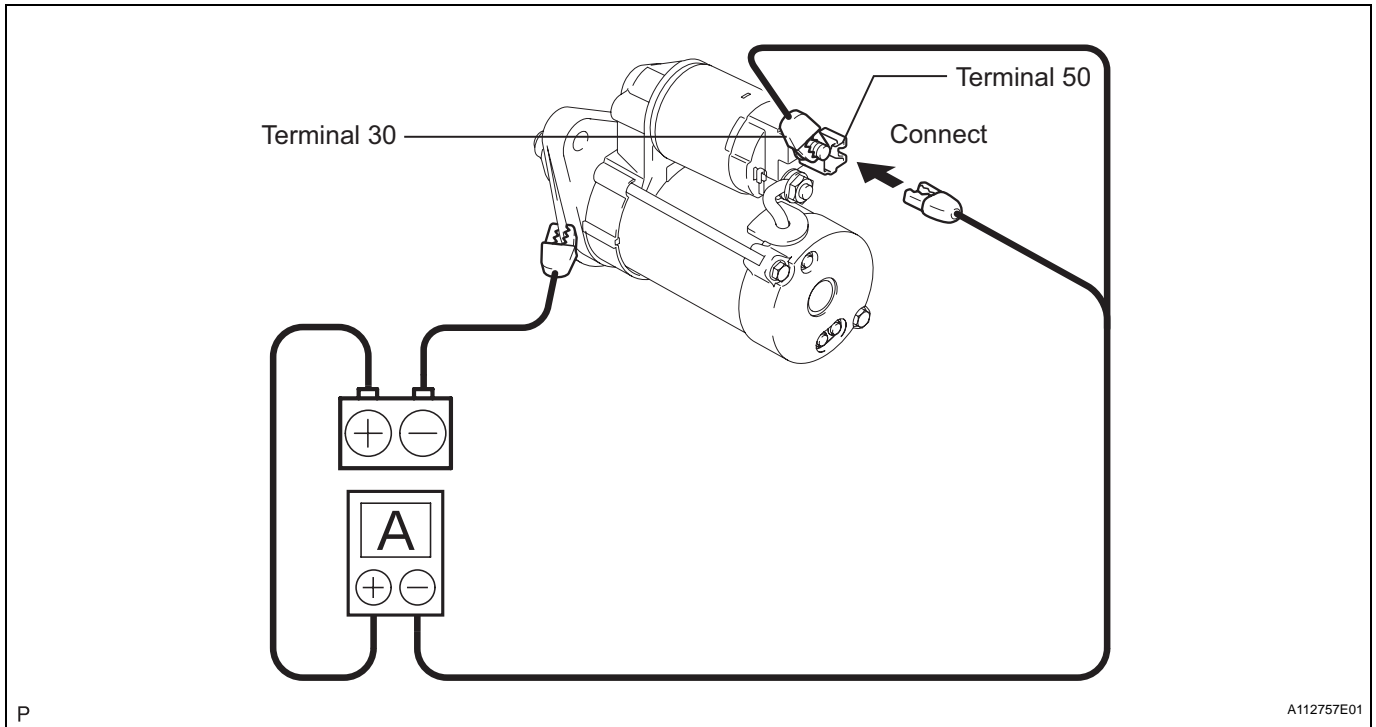

P

A112757E01

If the result is not as specified, replace the magnet switch body.