

(c) Remove the 3 bolts and canister.

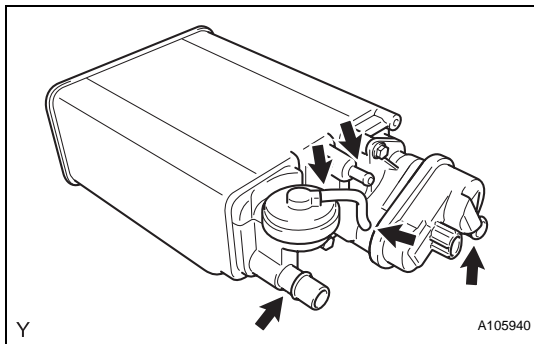

## INSPECTION

### 1. INSPECT CANISTER

(a) Visually check the canister for cracks or damage.  
If cracks or damage are found, replace the canister.

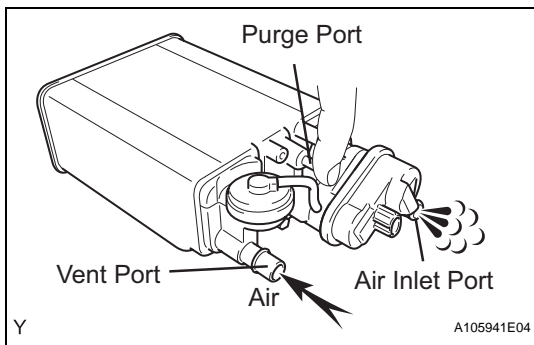

(b) Check the canister operation.

(1) While holding the purge port closed, blow air 0.39 kPa (4.0 kgf/cm<sup>2</sup>, 3 mmHg) into the vent port, and check that air flows from the air inlet port.  
If the result is not as specified, replace the canister.

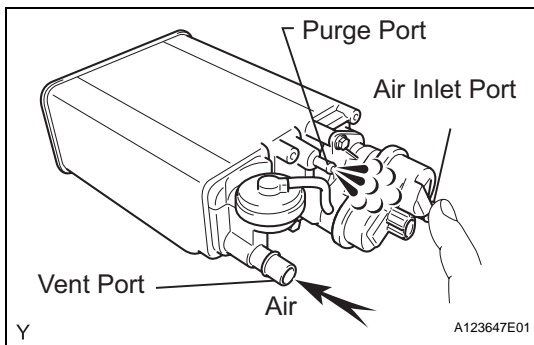

(2) While holding the air inlet port closed, blow air 0.39 kPa (4.0 kgf/cm<sup>2</sup>, 3 mmHg) into the vent port, and check that air flows from the purge port.  
If the result is not as specified, replace the canister.

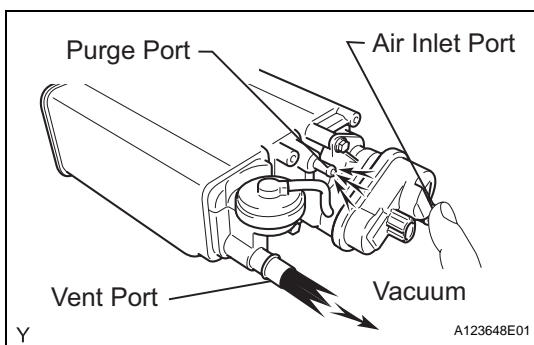

(3) While holding the air inlet port closed, apply vacuum 3.43 kPa (35.0 kgf/cm<sup>2</sup>, 25.7 mmHg) to the vent port, and check that air is sucked into the purge port.  
If the result is not as specified, replace the canister.

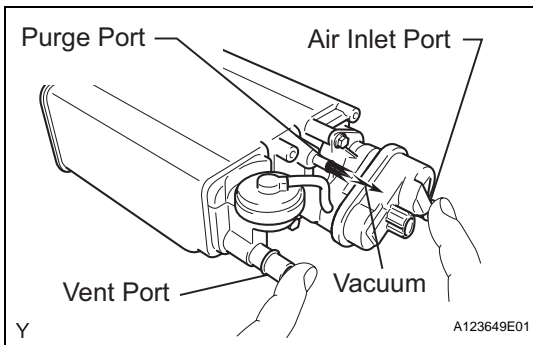

## (c) Check the air tightness.

- (1) While holding the vent and air inlet ports closed, apply vacuum 3.43 kPa (35.0 kgf/cm<sup>2</sup>, 25.7 mmHg) to the purge port, and check that the vacuum is maintained for 1 minute.  
If the result is not as specified, replace the canister.

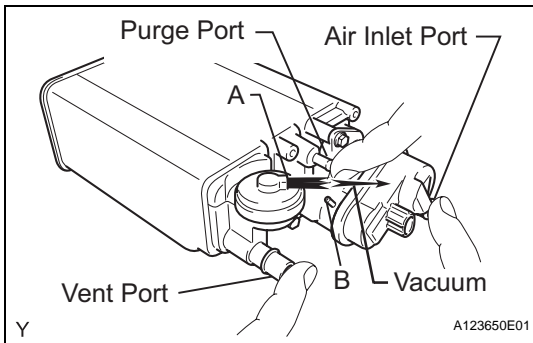

## (d) Check the diaphragm.

- (1) Remove the air hose between ports A and B.
- (2) While holding the vent, purge and air inlet ports closed, apply vacuum 1.42 kPa (14.5 kgf/cm<sup>2</sup>, 10.6 mmHg) port A, and check that air is not sucked into port B.

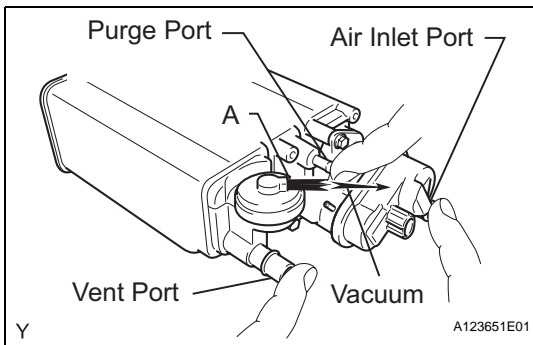

- (3) While holding the vent, purge and air inlet ports closed, apply vacuum 1.42 kPa (14.5 kgf/cm<sup>2</sup>, 10.6 mmHg) into port A, and measure how long it takes for the vacuum to drop.

**Vacuum drop time:****10 seconds or more**

If the result is not as specified, replace the canister.

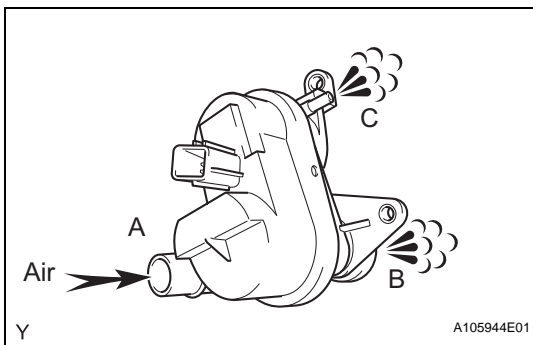

## (e) Check leak detection pump.

- (1) Check that air flows from port A to port B and C.  
If the result is not as specified, replace the canister.

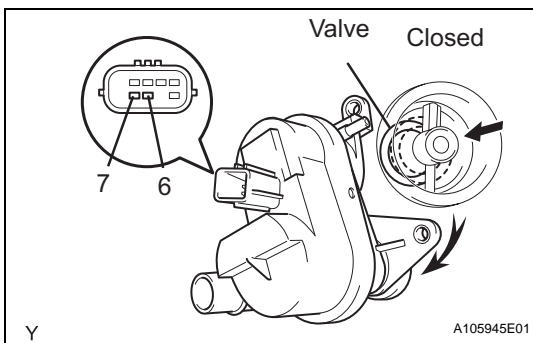

- (2) Connect the positive (+) lead of the battery to terminal 7 and the negative (-) lead to terminal 6.
- (3) Check that the valve is closed.  
If the result is not as specified, replace the canister.
- (4) Install the canister pump module.