

REAR AXLE HUB BOLT

COMPONENTS

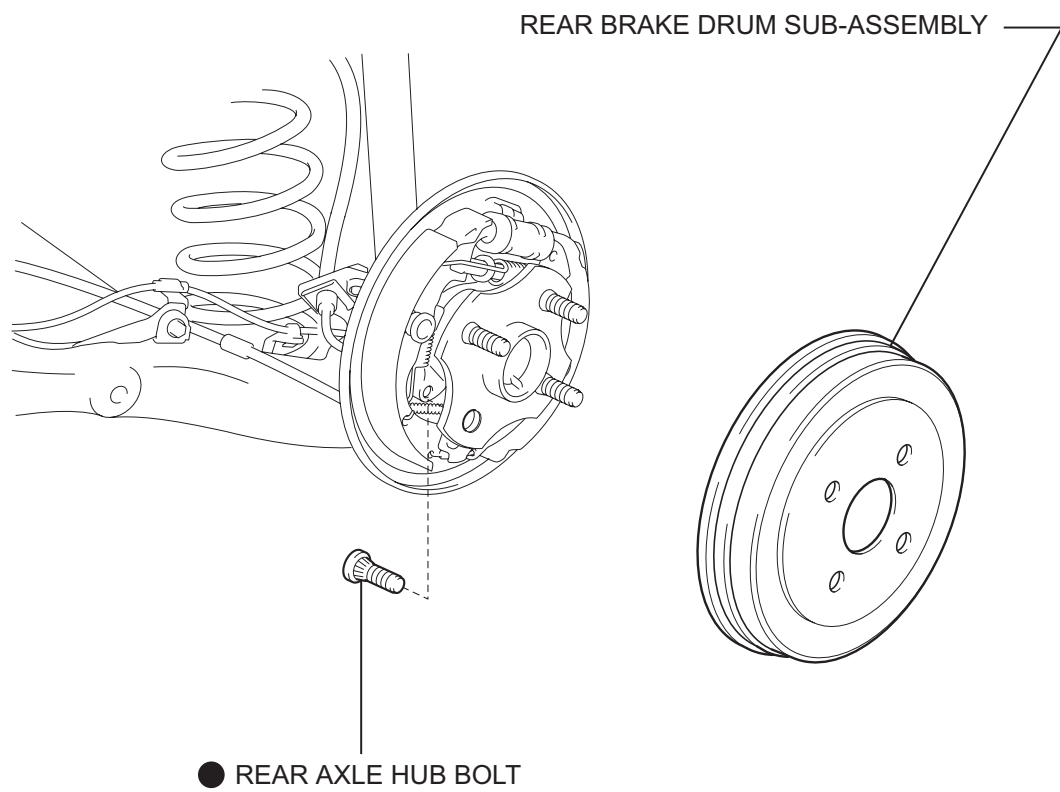

AH

● Non-reusable part

REPLACEMENT

HINT:

- Use the same procedures for the RH side and LH side.
- The procedures listed below are for the LH side.

1. REMOVE REAR WHEEL

2. REMOVE REAR BRAKE DRUM SUB-ASSEMBLY

3. REMOVE REAR AXLE HUB BOLT

- (a) Using SST and a screwdriver or an equivalent, remove the hub bolt.

SST 09628-10011

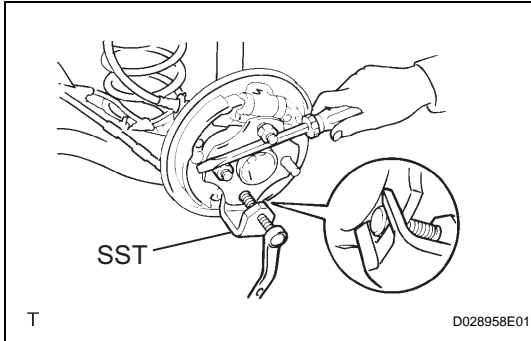

4. INSTALL REAR AXLE HUB BOLT

- (a) Install the washer and nut to a new hub bolt as shown in the illustration.
- (b) Using a screwdriver or an equivalent to hold the hub and bearing assembly, install the hub bolt by tightening the nut.

5. INSTALL REAR BRAKE DRUM SUB-ASSEMBLY

6. INSTALL REAR WHEEL

Torque: 103 N*m (1,050 kgf*cm, 76 ft.*lbf)

