

CLUTCH START SWITCH

COMPONENTS

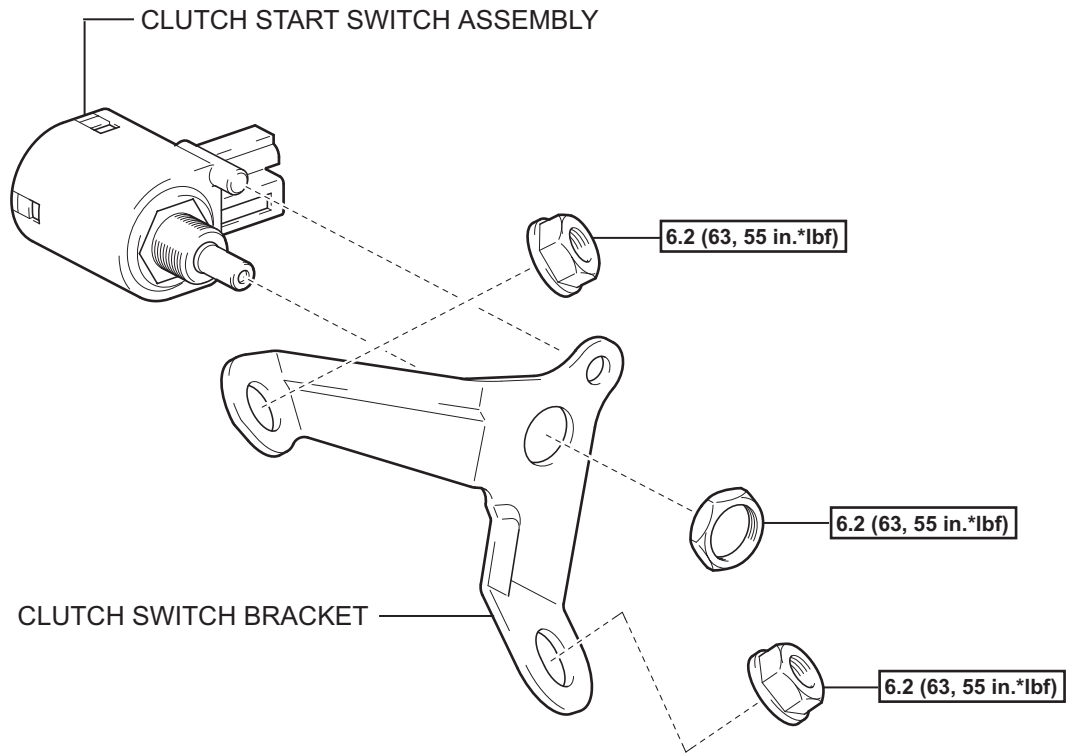

CL

N*m (kgf*cm, ft.*lbf) : Specified torque

ON-VEHICLE INSPECTION

1. CHECK CLUTCH START SYSTEM

- Check that the engine does not start when the clutch pedal is released.
- Check that the engine starts when the clutch pedal is fully depressed.
If necessary, replace the clutch start switch assembly.

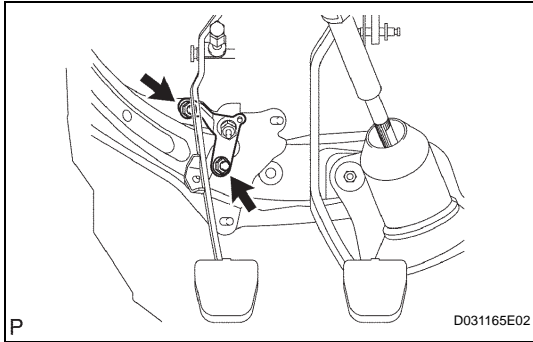

REMOVAL

1. REMOVE CLUTCH START SWITCH ASSEMBLY

- Disconnect the clutch start switch connector.
- Remove the 2 nuts and clutch start switch with the bracket.
- Remove the nut and clutch start switch from the bracket.

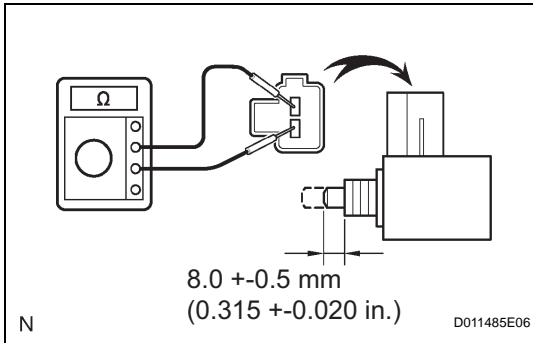

INSPECTION

1. INSPECT CLUTCH START SWITCH ASSEMBLY

- Measure the resistance between the terminals when the switch is ON and OFF.

Standard resistance

Switch Position	Specified Condition
ON (pushed)	Below 1 Ω
OFF (free)	10 k Ω or higher