

BACK DOOR SUPPORT

REMOVAL

HINT:

- Use the same procedure for the RH side and LH side.
- The procedures listed below are for the LH side.

1. REMOVE BACK DOOR STAY SUB-ASSEMBLY LH

- (a) Remove bolt A from the door panel.

HINT:

Remove the door stay while supporting the back door with one hand.

- (b) Remove the 2 bolts labeled B and the stay from the body panel.

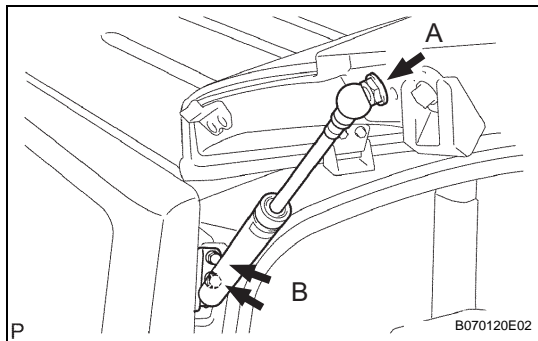

INSTALLATION

HINT:

- Use the same procedure for the RH side and LH side.
- The procedures listed below are for the LH side.
- A bolt without a torque specification is shown in the standard bolt chart (see page [SS-2](#)).

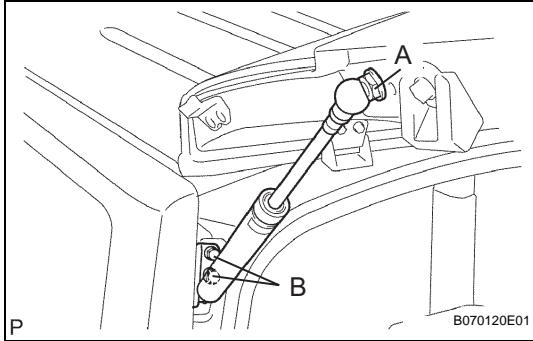

1. INSTALL BACK DOOR STAY SUB-ASSEMBLY LH

- (a) Install the stay with the 3 bolts.

Torque: 22.0 N*m (224 kgf*cm, 16 ft.*lbf) for bolt

A

8.0 N*m (82 kgf*cm, 71 ft.*lbf) for bolt B