

## DISASSEMBLY

### 1. REMOVE RADIATOR GRILLE LOWER

- (a) Using a screwdriver, detach the 9 claws and remove the grille lower.

### 2. REMOVE FRONT BUMPER EXTENSION MOUNTING BRACKET LH

- (a) Pull the mounting bracket in the direction indicated by the arrow labeled B. Then detach claws 1, 2 and 3.
- (b) Pull the mounting bracket in the direction indicated by the arrow labeled A. Then detach claw 4 and remove the mounting bracket.

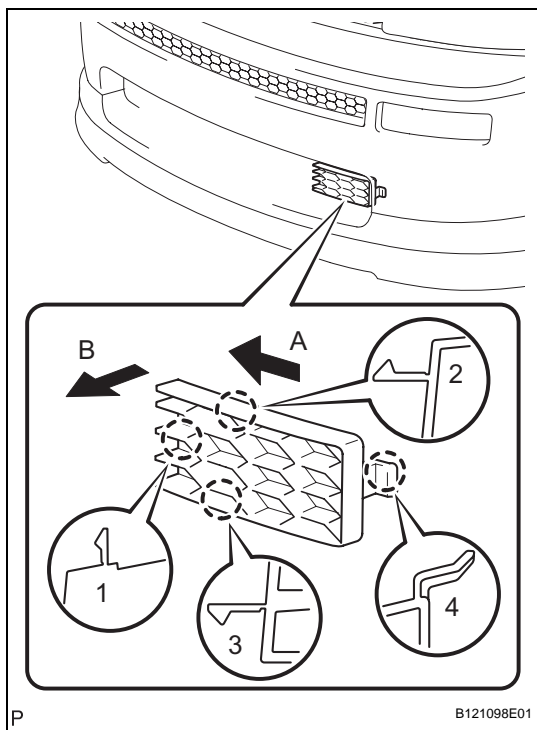

### 3. REMOVE FRONT BUMPER EXTENSION MOUNTING BRACKET RH

- HINT:  
Use the same procedures for the RH side and LH side.

### 4. REMOVE FRONT SPOILER

- (a) Remove the 4 screws.
- (b) Using a screwdriver, detach the 4 claws and remove the spoiler.

HINT:  
Tape the screwdriver tip before use.

### 5. REMOVE RADIATOR GRILLE UPPER

- (a) Using a screwdriver, detach the 13 claws and remove the grille upper.

HINT:  
Tape the screwdriver tip before use.

### 6. REMOVE FOG LIGHT COVER LH

- (a) Using a screwdriver, detach the 4 claws and remove the cover.

HINT:  
Tape the screwdriver tip before use.

### 7. REMOVE FOG LIGHT COVER RH

- HINT:  
Use the same procedures for the RH side and LH side.

## REASSEMBLY

1. **INSTALL FOG LIGHT COVER LH**  
(a) Attach the 4 claws to install the cover.
2. **INSTALL FOG LIGHT COVER RH**  
(a) Attach the 4 claws to install the cover.
3. **INSTALL RADIATOR GRILLE UPPER**  
(a) Attach the 13 claws to install the grille upper.
4. **INSTALL FRONT SPOILER**  
(a) Attach the 4 claws to install the spoiler.  
(b) Install the 4 screws.
5. **INSTALL FRONT BUMPER EXTENSION MOUNTING BRACKET LH**  
(a) Attach the 4 claws to install the mounting bracket.
6. **INSTALL FRONT BUMPER EXTENSION MOUNTING BRACKET RH**  
HINT:  
Use the same procedures for the RH side and LH side.
7. **INSTALL RADIATOR GRILLE LOWER**  
(a) Attach the 9 claws to install the grille lower.

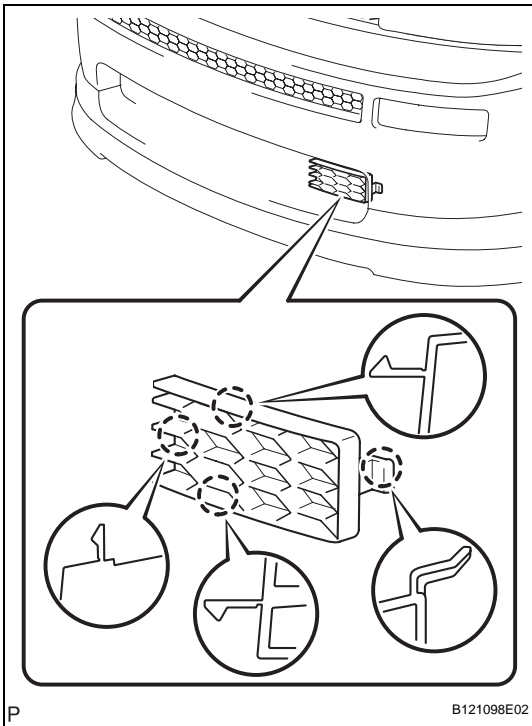

P

B121098E02