

# REAR CONSOLE BOX

## COMPONENTS

Automatic Transaxle

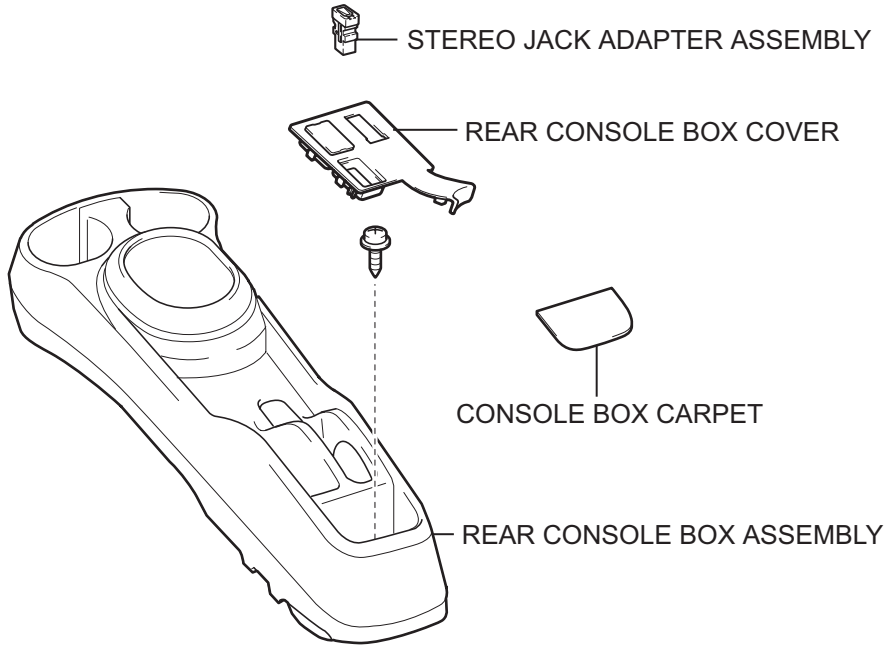

Manual Transaxle

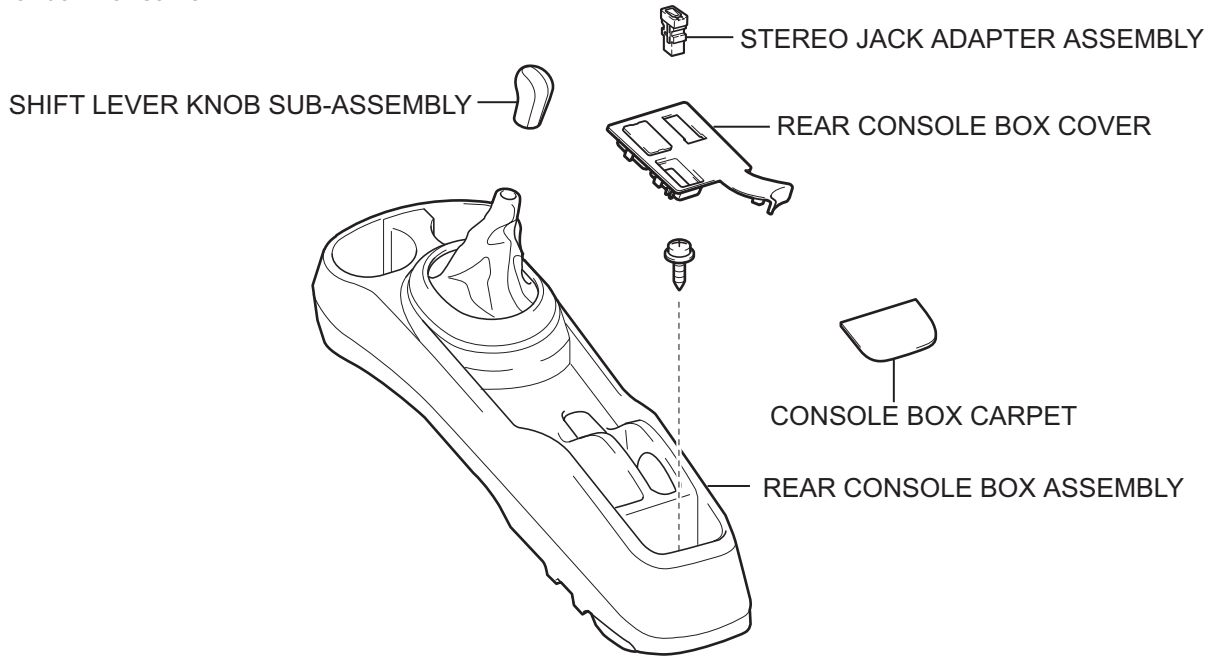

## REMOVAL

### 1. REMOVE SHIFT LEVER KNOB SUB-ASSEMBLY (for Manual Transaxle)

### 2. REMOVE REAR CONSOLE BOX ASSEMBLY

- (a) Using a screwdriver, detach the 8 claws and remove the rear console box cover.

HINT:

Tape the screwdriver tip before use.

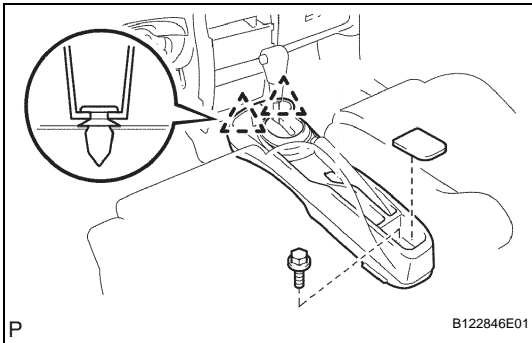
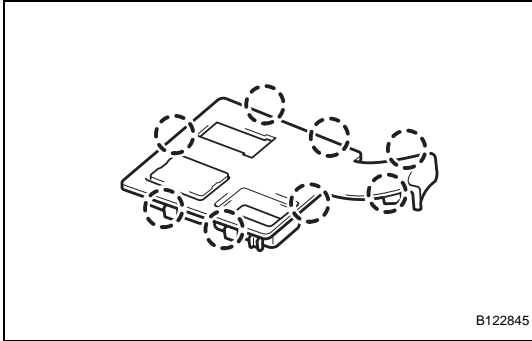

- (b) Remove the console box carpet.

- (c) Remove the screw.

- (d) Disconnect the connector.

- (e) Using a screwdriver, detach the 2 clips and remove the console box.

HINT:

Tape the screwdriver tip before use.

## DISASSEMBLY

### 1. REMOVE STEREO JACK ADAPTER ASSEMBLY

- (a) Detach the 2 claws and remove the stereo jack adapter.

- (b) Disconnect the connectors.

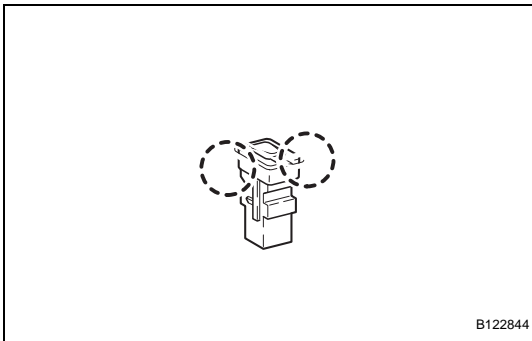

## REASSEMBLY

### 1. INSTALL STEREO JACK ADAPTER ASSEMBLY

- (a) Connect the connectors.

- (b) Attach the 2 claws to install the stereo jack adapter.

