

COMBINATION METER

COMPONENTS

ME

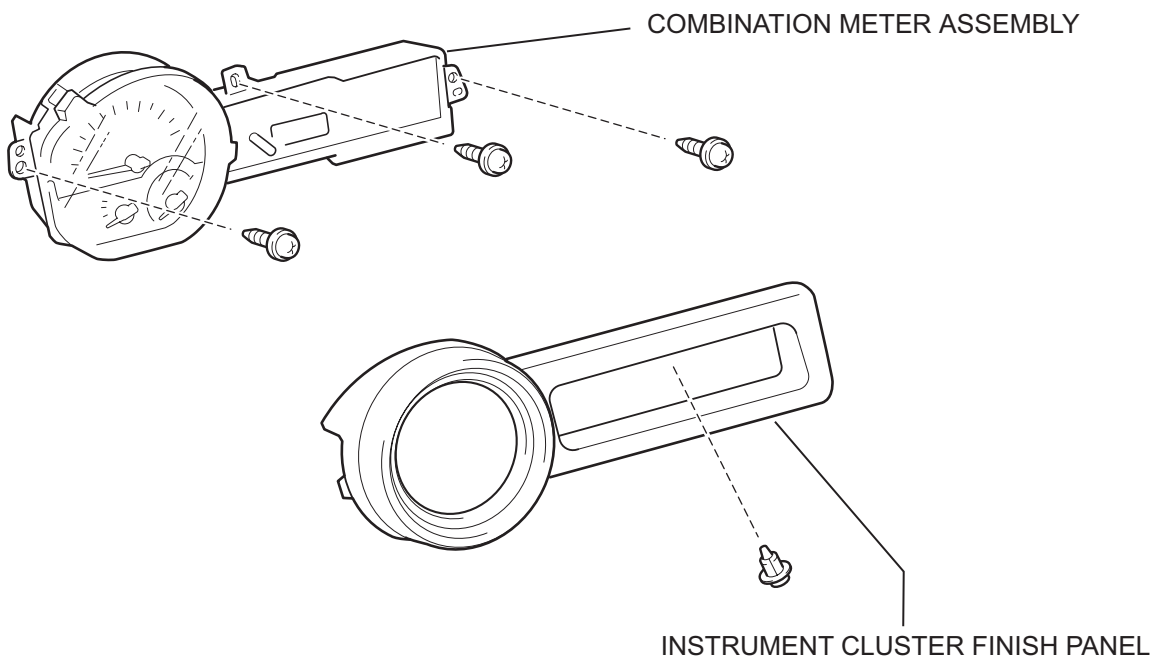
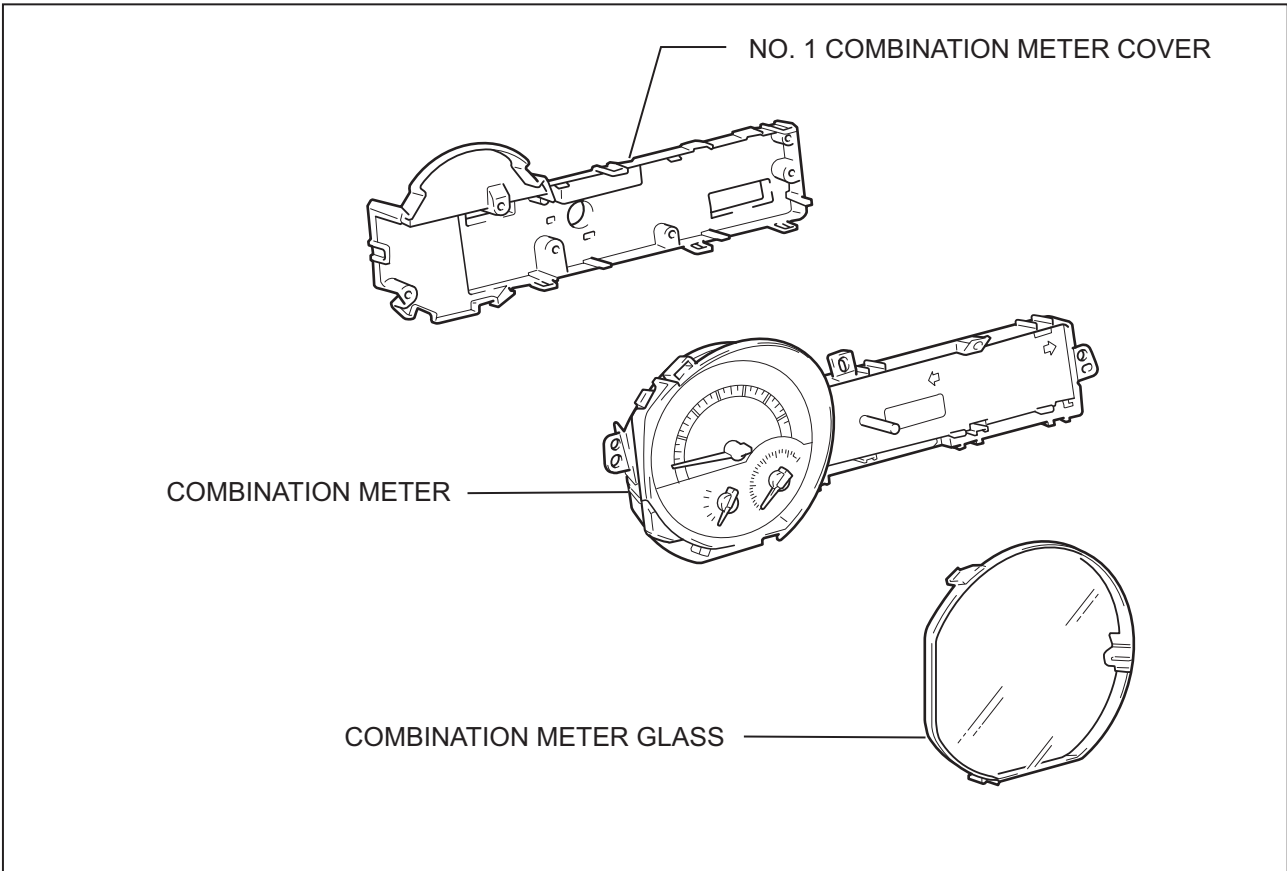

REMOVAL

1. **DISCONNECT CABLE FROM NEGATIVE BATTERY TERMINAL**

CAUTION:

Wait at least 90 seconds after disconnecting the cable from the negative (-) battery terminal to prevent airbag and seat belt pretensioner activation.

2. **REMOVE INSTRUMENT CLUSTER FINISH PANEL**

- (a) Remove the clip.
- (b) Using a screwdriver, detach the 7 claws and 2 clips, and remove the instrument cluster finish panel.

HINT:

Tape the screwdriver tip before use.

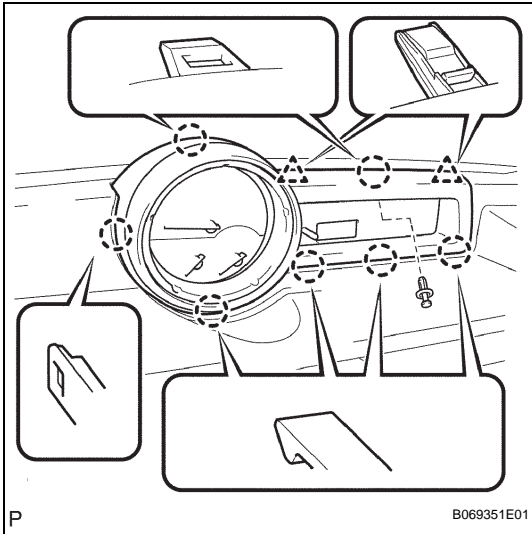

3. **REMOVE COMBINATION METER ASSEMBLY**

- (a) Remove the 3 screws.
- (b) Disconnect the connector, and remove the combination meter.

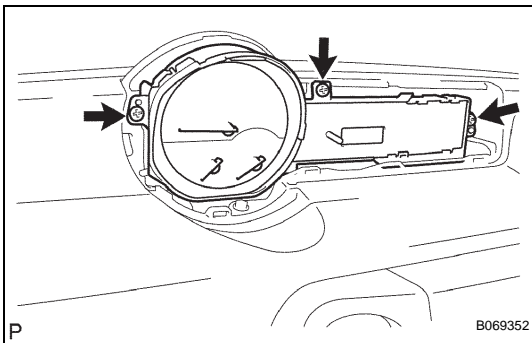

DISASSEMBLY

1. **REMOVE COMBINATION METER GLASS**

- (a) Using a screwdriver, detach the 3 claws and remove the combination meter glass.

HINT:

Tape the screwdriver tip before use.

2. **REMOVE NO. 1 COMBINATION METER COVER**

- (a) Using a screwdriver, detach the 6 claws and remove the combination meter cover.

HINT:

Tape the screwdriver tip before use.

