

## REASSEMBLY

### CAUTION:

Wear protective gloves. Sharp areas on the seatback frame may injure your hands.

#### 1. INSTALL REAR SEAT BELT ASSEMBLY OUTER CENTER

- (a) Install the belt with the nut.

**Torque: 42 N\*m (428 kgf\*cm, 31 ft.\*lbf)**

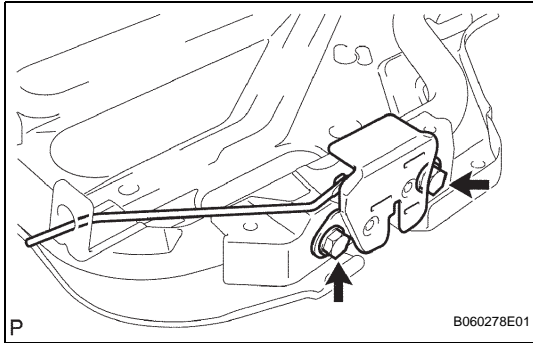

#### 2. INSTALL REAR SEATBACK LOCK ASSEMBLY LH

- (a) Install the lock with the 2 bolts.

#### 3. INSTALL REAR SEATBACK LOCK ASSEMBLY RH

- (a) Install the lock with the 2 bolts.

#### 4. INSTALL REAR SEATBACK COVER WITH PAD LH

- (a) Install the seatback cover (with pad) to the seatback frame.

### NOTICE:

**Be careful not to damage the cover.**

#### 5. INSTALL REAR SEATBACK COVER WITH PAD RH

### HINT:

Use the same procedures described for the LH side.

#### 6. INSTALL REAR SEATBACK STOP BUTTON GROMMET

- (a) Attach the claws to install the 2 grommets.

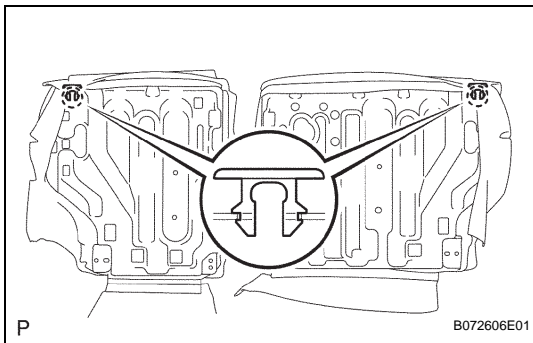

#### 7. INSTALL REAR SEAT HEADREST SUPPORT

- (a) Attach the claws to install the 6 headrest supports.

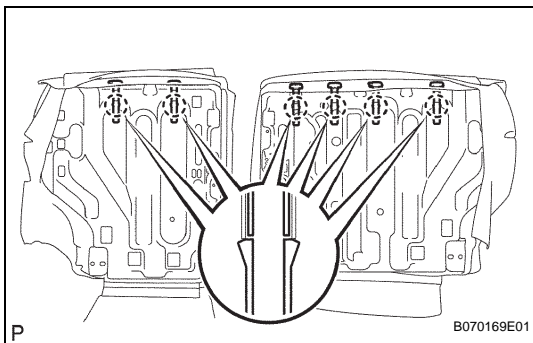

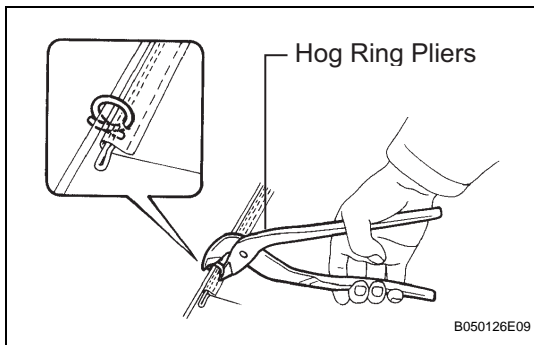

- (b) Using hog ring pliers, install the seatback cover (with pad) to the seatback frame with new hog rings.

**NOTICE:**

- Be careful not to damage the cover.
- When installing the hog rings, avoid wrinkling the cover.

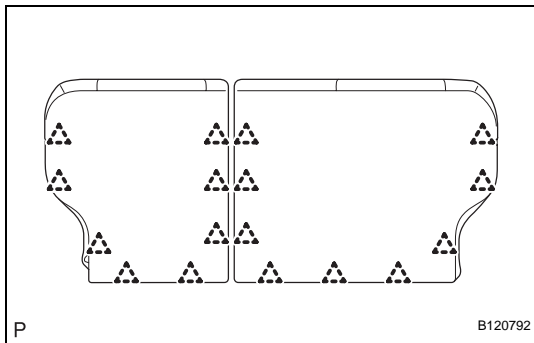

- (c) Install the 17 clips.

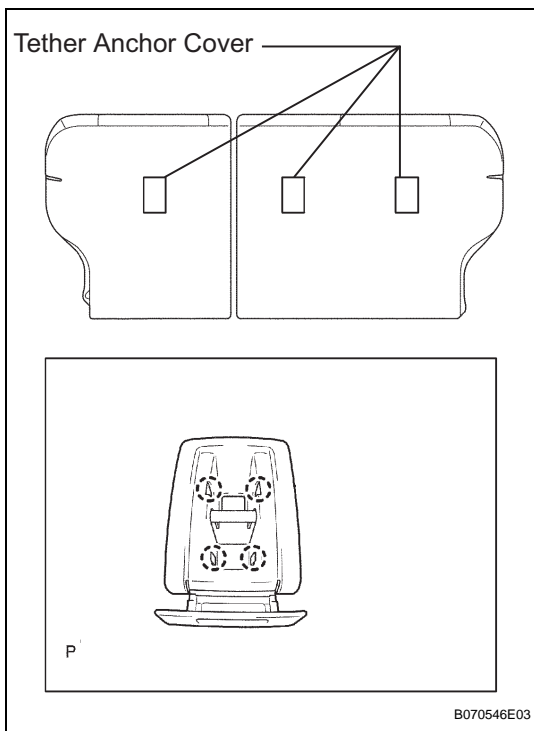

**8. INSTALL TETHER ANCHOR COVER**

- (a) Install the 3 tether anchor covers.

SE

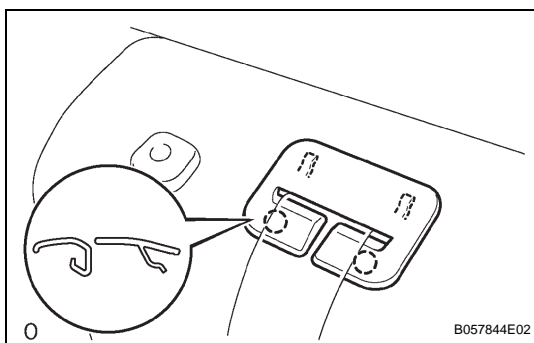

**9. INSTALL REAR SEAT SHOULDER BELT COVER (for RH Side)**

- (a) Attach the claws to install the shoulder belt cover.

**10. INSTALL REAR SEATBACK LOCK RELEASE BUTTON**

- (a) Install the 2 buttons.

**11. INSTALL REAR SEATBACK HINGE SUB-ASSEMBLY LH**

- (a) Install the seatback hinge with the bolt.  
Torque: 42 N\*m (428 kgf\*cm, 31 ft.\*lbf)

**12. INSTALL REAR SEATBACK HINGE SUB-ASSEMBLY  
RH**

- (a) Install the seatback hinge with the bolt.  
**Torque: 42 N\*m (428 kgf\*cm, 31 ft.\*lbf)**

**13. INSTALL REAR SEAT HEADREST ASSEMBLY**

- (a) Install the 3 headrests.