

## INSTALLATION

### 1. INSTALL CHILD RESTRAINT SEAT ANCHOR BRACKET SUB-ASSEMBLY

- (a) Install the anchor bracket with the 4 bolts.  
**Torque: 42 N\*m (428 kgf\*cm, 31 ft.\*lbf)**

### 2. INSTALL REAR SEATBACK LOCK STRIKER SUB-ASSEMBLY LH

- (a) Install the seatback lock striker with the 2 bolts.  
**Torque: 21 N\*m (214 kgf\*cm, 15 ft.\*lbf)**

### 3. INSTALL REAR SEATBACK LOCK STRIKER SUB-ASSEMBLY RH

- (a) Install the seatback lock striker with the 2 bolts.  
**Torque: 21 N\*m (214 kgf\*cm, 15 ft.\*lbf)**

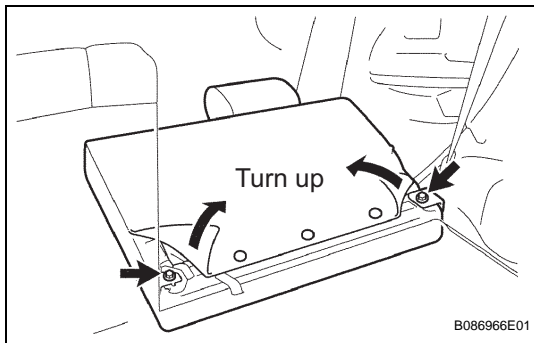

### 4. INSTALL REAR SEATBACK ASSEMBLY LH

- (a) Turn up the seatback cover as shown in the illustration.  
 (b) Install the seatback with the 2 bolts.  
**Torque: 37 N\*m (377 kgf\*cm, 27 ft.\*lbf)**  
 (c) Return the seatback to the upright position.

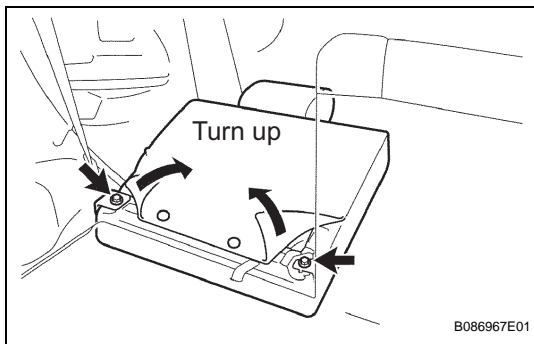

### 5. INSTALL REAR SEATBACK ASSEMBLY RH

- HINT:**  
 Use the same procedures described for the LH side.  
**Torque: 37 N\*m (377 kgf\*cm, 27 ft.\*lbf)**

### 6. INSTALL REAR SEAT CUSHION WITH COVER PAD SUB-ASSEMBLY

- (a) Attach the seat cushion's rear hook.  
 (b) Attach the seat cushion's 2 front hooks to the vehicle body.  
 (c) Confirm that the seat cushion is firmly installed.

**NOTICE:**

**When installing the seat cushion, make sure the seat belt buckle is not under the seat cushion.**

