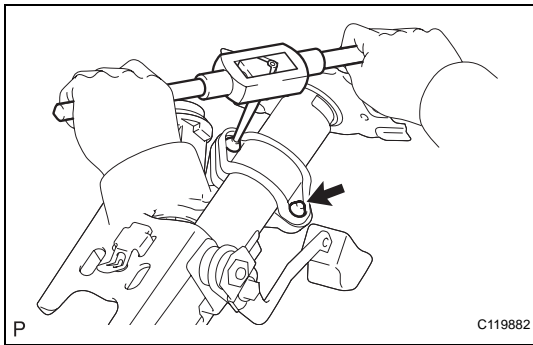
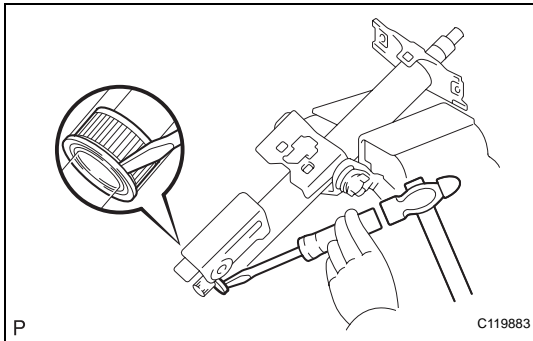
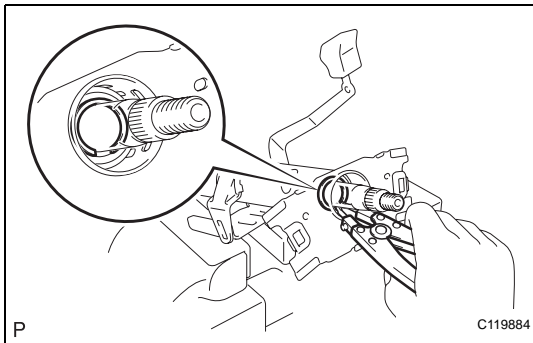

DISASSEMBLY**1. REMOVE STEERING COLUMN UPPER WITH SWITCH BRACKET ASSEMBLY**

- (a) Using a centering punch, mark the center of the 2 tapered-head bolts.
- (b) Using a 3 to 4 mm (0.12 to 0.16 in.) drill, drill a hole in the 2 bolt heads.
- (c) Using a screw extractor, remove the 2 bolts, steering column clamp and steering column upper with switch bracket.

**2. REMOVE STEERING MAIN SHAFT BUSH**

- Using a screwdriver and hammer, tap out the steering main shaft bush.

**3. REMOVE STEERING MAIN SHAFT ASSEMBLY**

- (a) Using a snap ring expander, remove the snap ring on the upper side.

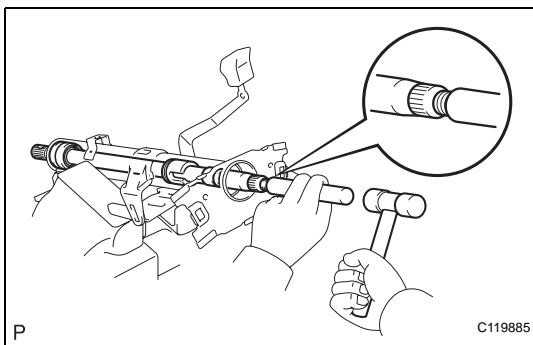

- (b) Using an extension bar and hammer, tap out the steering main shaft.

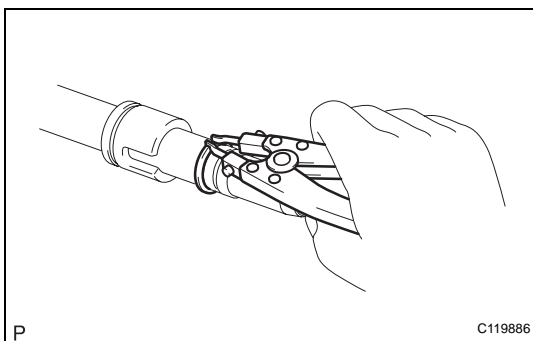

- (c) Using a snap ring expander, remove the snap ring on the lower side.

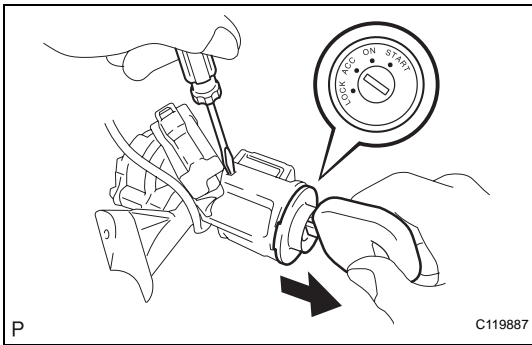

4. REMOVE IGNITION SWITCH LOCK CYLINDER ASSEMBLY

- (a) Place the ignition switch lock cylinder in the ACC position.
- (b) Push down the stop pin with a screwdriver, and pull out the cylinder.

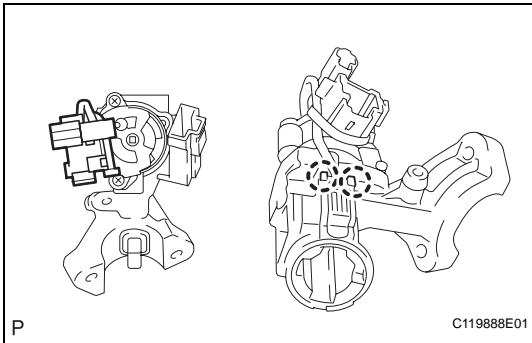

5. REMOVE UNLOCK WARNING SWITCH ASSEMBLY

- (a) Disconnect the unlock warning switch connector from the ignition switch.
- (b) Remove the unlock warning switch.

6. REMOVE IGNITION SWITCH ASSEMBLY

- (a) Remove the 2 screws and ignition or starter switch from the steering column bracket.