

FRONT SUSPENSION NO. 1 LOWER ARM (for Automatic Transaxle)

COMPONENTS

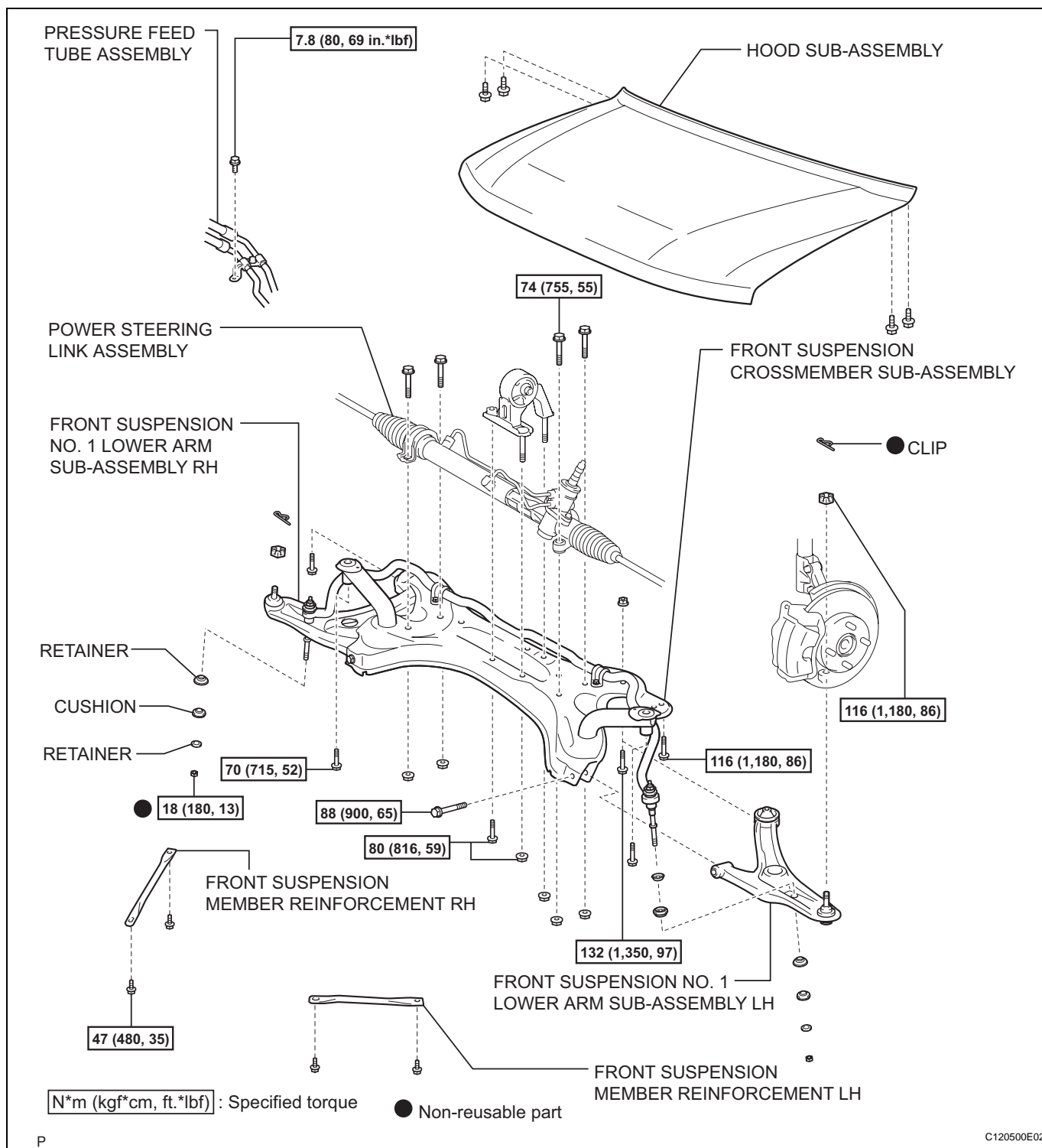

REMOVAL

HINT:

The removal procedures on the front suspension No. 1 lower arm sub-assembly can be performed without removing the power steering link and front suspension crossmember.

1. REMOVE FRONT WHEEL
2. REMOVE HOOD SUB-ASSEMBLY
3. SUSPEND ENGINE ASSEMBLY
4. DISCONNECT FRONT SUSPENSION NO. 1 LOWER ARM SUB-ASSEMBLY LH
 - (a) Remove the clip and nut.
 - (b) Using SST, disconnect the lower arm from the steering knuckle.

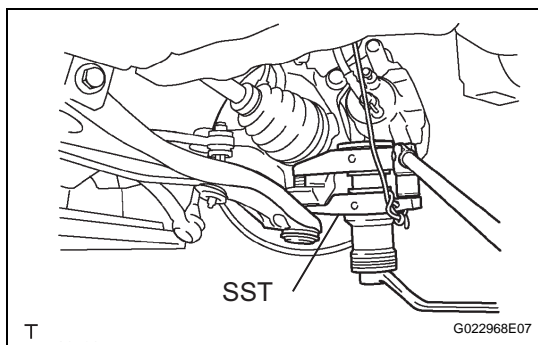

5. DISCONNECT FRONT SUSPENSION NO. 1 LOWER ARM SUB-ASSEMBLY RH

HINT:

Use the same procedures described for the LH side.

6. DISCONNECT FRONT STABILIZER BAR
 - (a) While holding the front stabilizer bolt with the spanner, remove the nut.
 - (b) Remove the 2 retainers and cushion, and then remove the front stabilizer bolt.
 - (c) Perform the procedure above on the other side.

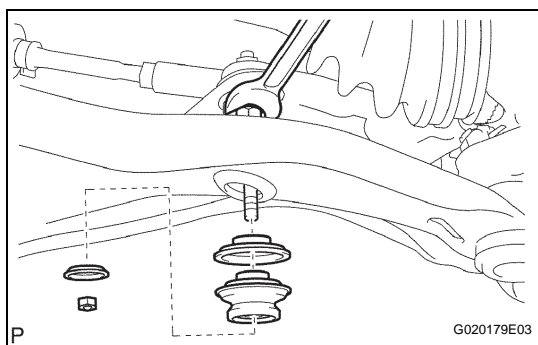

7. DISCONNECT POWER STEERING LINK ASSEMBLY
 - (a) Remove the 4 bolts and 4 nuts, and disconnect the steering link.

HINT:

Perform this procedure with the steering link suspended.

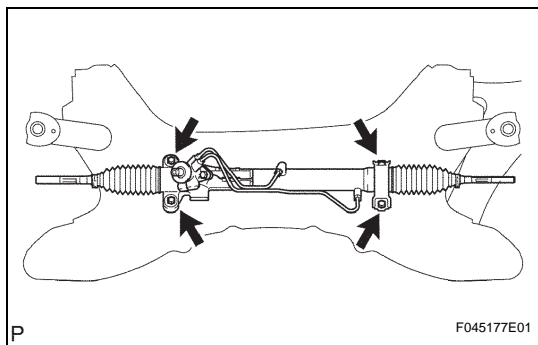

8. DISCONNECT PRESSURE FEED TUBE ASSEMBLY
 - (a) Remove the bolt and disconnect the pressure feed tube.
9. REMOVE FRONT SUSPENSION MEMBER REINFORCEMENT LH
 - (a) Remove the 2 bolts and reinforcement.
10. REMOVE FRONT SUSPENSION MEMBER REINFORCEMENT RH
 - (a) Remove the 2 bolts and reinforcement.

