

FRONT STABILIZER BAR

COMPONENTS

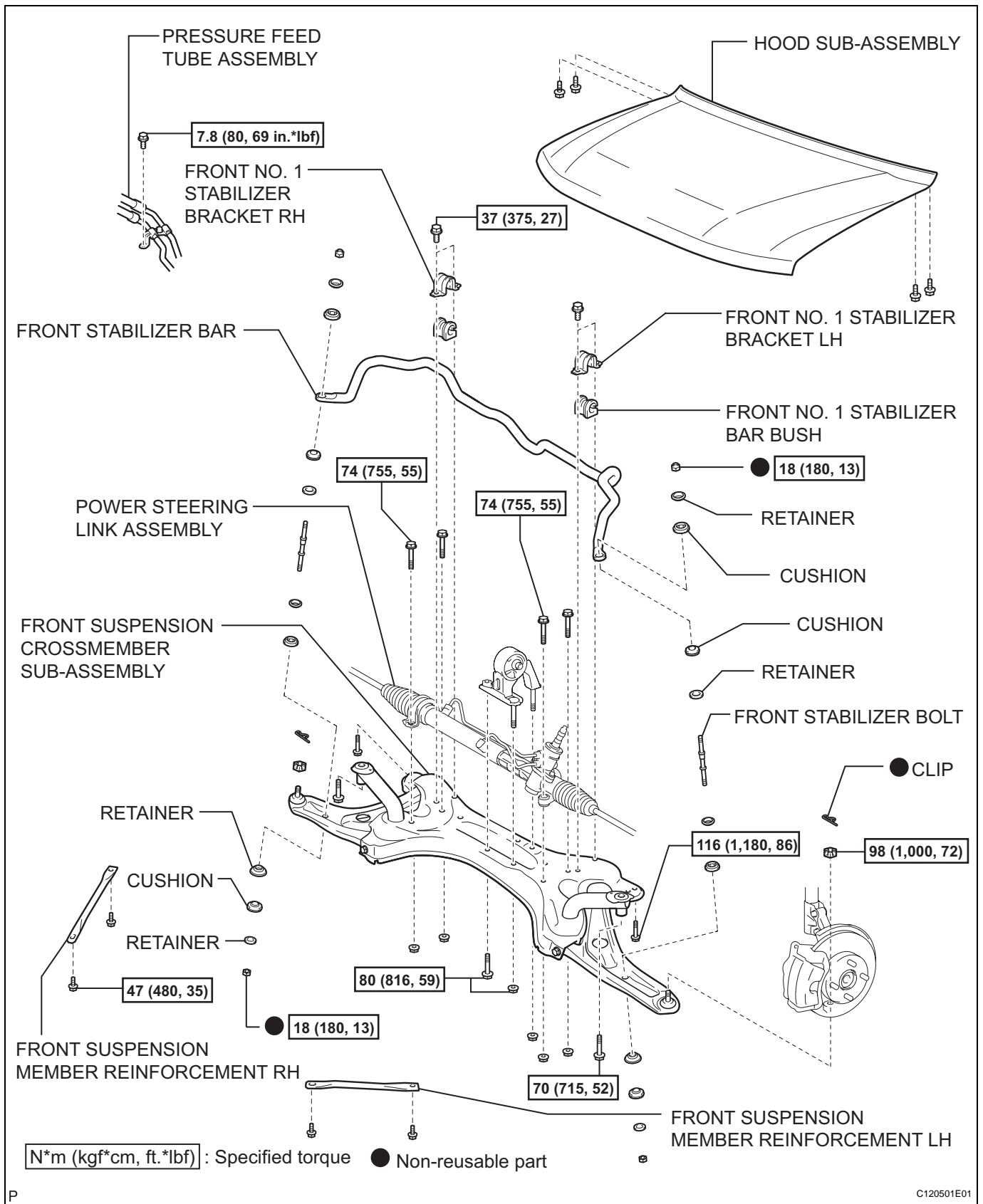

SP

REMOVAL

1. REMOVE FRONT WHEEL
2. REMOVE HOOD SUB-ASSEMBLY
3. SUSPEND ENGINE ASSEMBLY
4. DISCONNECT FRONT SUSPENSION NO. 1 LOWER ARM SUB-ASSEMBLY LH (See page [SP-16](#))
5. DISCONNECT FRONT SUSPENSION NO. 1 LOWER ARM SUB-ASSEMBLY RH (See page [SP-16](#))
6. DISCONNECT FRONT STABILIZER BAR (See page [SP-16](#))
7. DISCONNECT POWER STEERING LINK ASSEMBLY (See page [SP-16](#))
8. DISCONNECT PRESSURE FEED TUBE ASSEMBLY (See page [SP-16](#))
9. DISCONNECT FRONT SUSPENSION CROSSMEMBER SUB-ASSEMBLY (See page [SP-17](#))
10. REMOVE FRONT STABILIZER BAR
 - (a) Remove the 4 bolts, 2 bushes and No. 1 stabilizer bracket LH and RH.
 - (b) Remove the stabilizer bar.

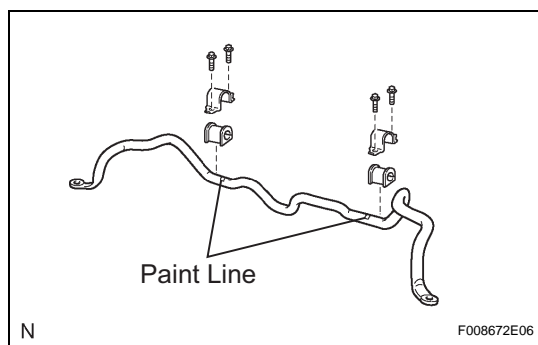
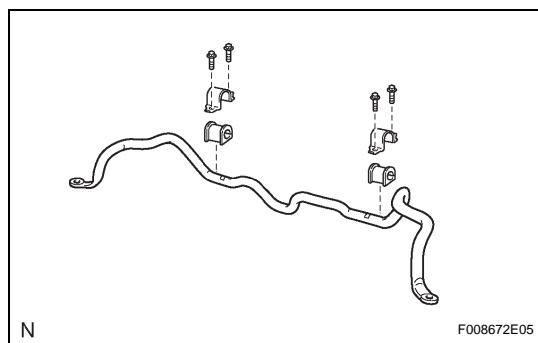

INSTALLATION

1. INSTALL FRONT STABILIZER BAR
 - (a) Install the stabilizer bar, 2 bushes and 2 brackets with the 4 bolts.
Torque: 37 N*m (377 kgf*cm, 27 ft.*lbf)
NOTICE:
Install the bushes with the slit facing the rear of the vehicle.
HINT:
Install the bushes on the outside of each paint line.
2. CONNECT FRONT SUSPENSION CROSSMEMBER SUB-ASSEMBLY (See page [SP-18](#))
3. CONNECT PRESSURE FEED TUBE ASSEMBLY (See page [SP-18](#))
4. CONNECT POWER STEERING LINK ASSEMBLY (See page [SP-18](#))
5. CONNECT FRONT STABILIZER BAR (See page [SP-19](#))
6. CONNECT FRONT SUSPENSION NO. 1 LOWER ARM SUB-ASSEMBLY LH (See page [SP-19](#))

7. **CONNECT FRONT SUSPENSION NO. 1 LOWER ARM SUB-ASSEMBLY RH** (See page [SP-19](#))
8. **INSTALL FRONT WHEEL**
Torque: 103 N*m (1,050 kgf*cm, 76 ft.*lbf)
9. **INSTALL HOOD SUB-ASSEMBLY**
10. **INSPECT HOOD SUB-ASSEMBLY**
(a) Inspect the hood (see page [ED-1](#)).
11. **ADJUST HOOD SUB-ASSEMBLY**
(a) Adjust the hood (see page [ED-1](#)).
12. **INSPECT AND ADJUST FRONT WHEEL ALIGNMENT**
(a) Inspect and adjust the front wheel alignment (see page [SP-2](#)).