

15. REMOVE REAR AXLE BEAM ASSEMBLY

- Support the axle beam with a jack.
- Remove the 2 bolts and the axle beam.

DISASSEMBLY

1. REMOVE REAR AXLE CARRIER BUSH LH

- Using a chisel and hammer, bend the 2 portions of the bush's rib.

HINT:

Bend the bush's rib until the claw of SST can be hung as shown in the illustration.

- Using SST, remove the bush from the axle beam.

SST 09309-37010, 09950-40011 (09951-04010, 09952-04010, 09953-04010, 09954-04020, 09955-04051, 09957-04010, 09958-04011)

NOTICE:

If the axle beam has been scratched, apply paint.

2. REMOVE REAR AXLE CARRIER BUSH RH

HINT:

Use the same procedures described for the LH side.

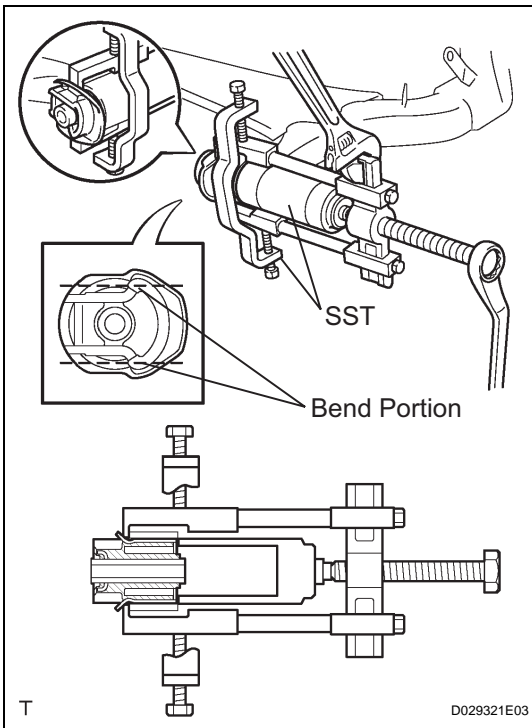

REASSEMBLY

1. INSTALL REAR AXLE CARRIER BUSH LH

- Position the axle carrier bush with the axle beam as shown in the illustration.

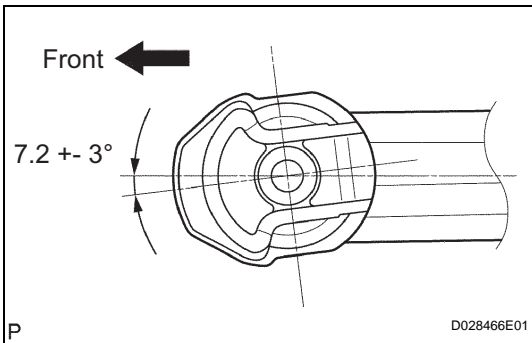

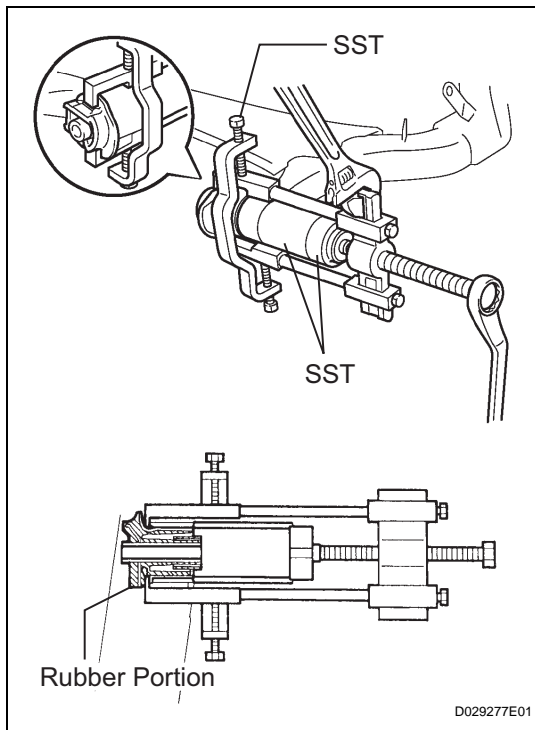

- (b) Using SST, install the bushes on the axle beam.
SST 09710-14013 (09710-00021), 09950-40011
 (09951-04010, 09952-04010, 09953-04030,
 09954-04020, 09955-04031, 09957-04010,
 09958-04011), 09950-60010 (09951-00560)

NOTICE:

- Hang the claw of SST to the bush deeply and firmly.
- Do not scratch the rubber portion of the bush.
- Do not deform the bush's rib.

2. INSTALL REAR AXLE CARRIER BUSH RH**HINT:**

Use the same procedures described for the LH side.

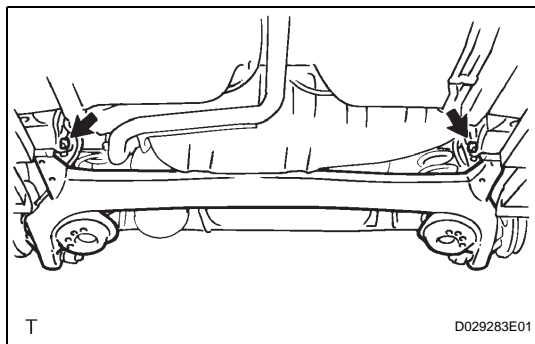
**INSTALLATION****1. TEMPORARILY INSTALL REAR AXLE BEAM ASSEMBLY**

- (a) Support the axle beam with a jack.
 (b) Install the axle beam, and temporarily install the 2 bolts.

2. INSTALL REAR COIL SPRING LH (See page SP-28)**3. INSTALL REAR COIL SPRING RH****HINT:**

Use the same procedures described for the LH side.

4. TEMPORARILY INSTALL REAR SHOCK ABSORBER ASSEMBLY LH (See page SP-28)**5. TEMPORARILY INSTALL REAR SHOCK ABSORBER ASSEMBLY RH****HINT:**

Use the same procedures described for the LH side.

6. INSTALL REAR AXLE HUB AND BEARING ASSEMBLY LH

- (a) Install the brake and the axle hub and bearing with the 4 bolts.

Torque: 61 N*m (622 kgf*cm, 45 ft.*lbf)

7. INSTALL REAR AXLE HUB AND BEARING ASSEMBLY RH**HINT:**

Use the same procedures described for the LH side.

8. INSTALL REAR BRAKE DRUM SUB-ASSEMBLY

- (a) Install the rear brake drum (see page BR-37).

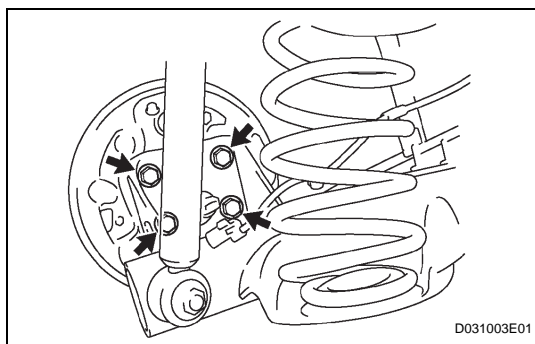

9. **ADJUST REAR DRUM BRAKE SHOE CLEARANCE**
 - (a) Adjust the rear drum brake shoe clearance (see page [BR-38](#)).
10. **CONNECT NO. 3 PARKING BRAKE CABLE ASSEMBLY** (See page [SP-29](#))
11. **CONNECT NO. 2 PARKING BRAKE CABLE ASSEMBLY** (See page [SP-29](#))
12. **CONNECT REAR NO. 4 BRAKE TUBE** (See page [SP-29](#))
13. **CONNECT REAR NO. 3 BRAKE TUBE** (See page [SP-29](#))
14. **CONNECT SKID CONTROL SENSOR WIRE** (See page [SP-29](#))
15. **FULLY TIGHTEN REAR AXLE BEAM ASSEMBLY**
Torque: 82 N*m (836 kgf*cm, 60 ft.*lbf)
16. **FULLY TIGHTEN REAR SHOCK ABSORBER ASSEMBLY LH** (See page [SP-29](#))
17. **FULLY TIGHTEN REAR SHOCK ABSORBER ASSEMBLY RH**
HINT:
Use the same procedures described for the LH side.
18. **BLEED BRAKE LINE**
 - (a) Bleed the brake line (see page [BR-3](#)).
19. **INSTALL REAR WHEEL**
Torque: 103 N*m (1,050 kgf*cm, 76 ft.*lbf)
20. **INSPECT REAR WHEEL ALIGNMENT**
 - (a) Inspect the rear wheel alignment (see page [SP-8](#)).
21. **CHECK ABS SPEED SENSOR SIGNAL**
 - (a) Check the ABS speed sensor signal (see page [BC-15](#)).