

- (2) Clean the contact surface of the vehicle body with cleaner.

HINT:

Even if all the adhesive has been removed, clean the vehicle body.

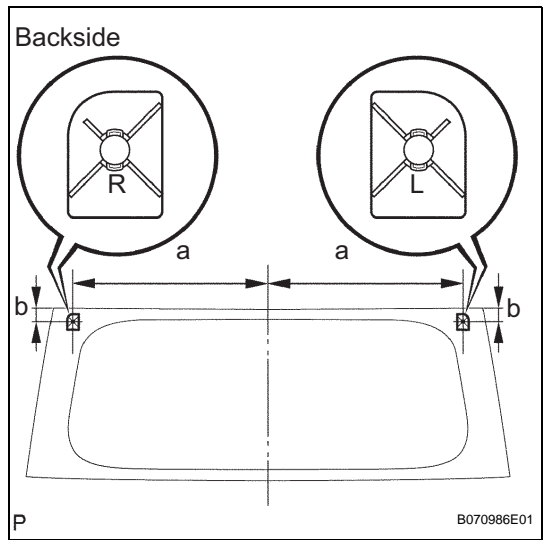

INSTALLATION

1. INSTALL BACK WINDOW GLASS CLIP

- (a) Apply Primer G to the installation part of the clips.

HINT:

If primer is applied to an area that is not specified, wipe off the primer with white gasoline before it dries.

- (b) Install new clips.

NOTICE:

- Allow the primer to dry for 3 minutes or more.
- Throw away any leftover primer.
- Do not apply too much primer.

Standard measurement

Area	Specified Condition
a	528.8 mm (20.819 in.)
b	35.8 mm (1.409 in.)

2. INSTALL BACK WINDOW GLASS SPACER

- (a) Apply Primer G to the glass where the spacers will be installed.

HINT:

If primer is applied to an area that is not specified, wipe off the primer with white gasoline before it dries.

- (b) Install 4 new spacers.

NOTICE:

- Allow the primer to dry for 3 minutes or more.
- Throw away any leftover primer.
- Do not apply too much primer.

Standard measurement

Area	Specified Condition
a	15.0 mm (0.591 in.)
b	220 mm (8.661 in.)
c	220 mm (8.661 in.)
d	18.0 mm (0.708 in.)

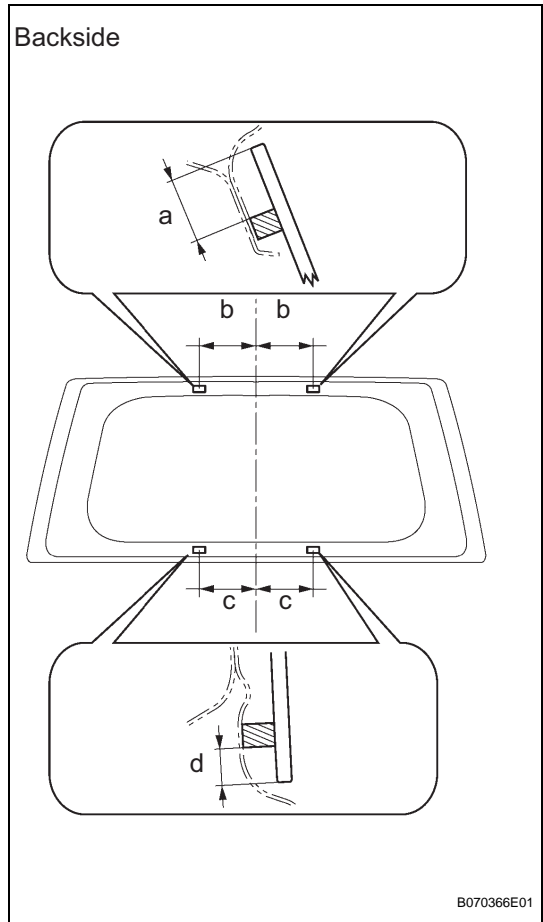

3. INSTALL BACK DOOR WINDOW MOULDING

- (a) Apply Primer G to the installation part of the window moulding.

NOTICE:

- Allow the primer to dry for 3 minutes or more.
- Throw away any leftover primer.
- Do not apply too much primer.

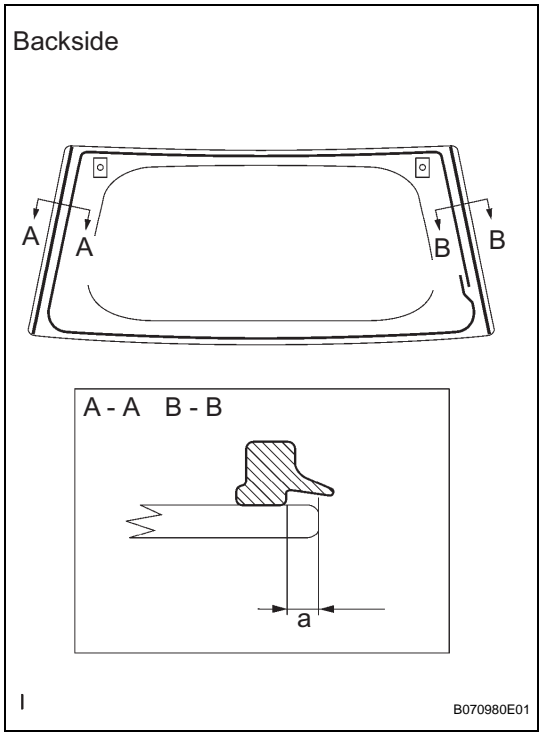

- (b) Install a new moulding LH and RH as shown in the illustration.

Standard measurement

Area	Specified Condition
a	3.0 mm (0.118 in.)

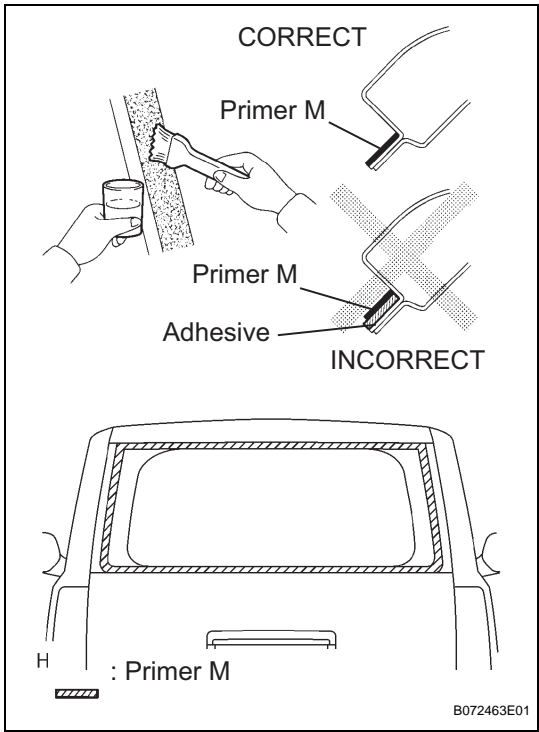

4. INSTALL BACK DOOR GLASS

- (a) Using a brush or sponge, apply Primer M to the exposed part of the vehicle body.

NOTICE:

- Allow the primer to dry for 3 minutes or more.
- Do not apply primer to the adhesive.
- Throw away any leftover primer.
- Do not apply too much primer.

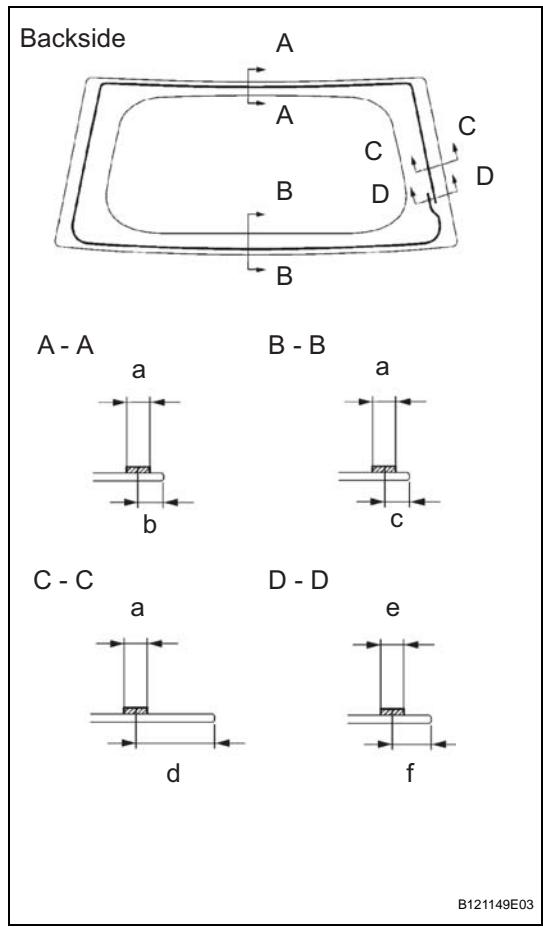

- (b) Using a brush or sponge, apply Primer G to the contact surface of the back door glass.

Standard measurement

Area	Specified Condition
a	14.0 mm (0.551 in.)
b	10.0 mm (0.394 in.)
c	12.8 mm (0.504 in.)
d	30.0 mm (1.181 in.)
e	22.0 mm (0.866 in.)
f	38.0 mm (1.496 in.)

HINT:

If primer is applied to an area that is not specified, wipe off the primer with white gasoline before it dries.

NOTICE:

- Allow the primer to dry for 3 minutes or more.
- Throw away any leftover primer.
- Do not apply too much primer.

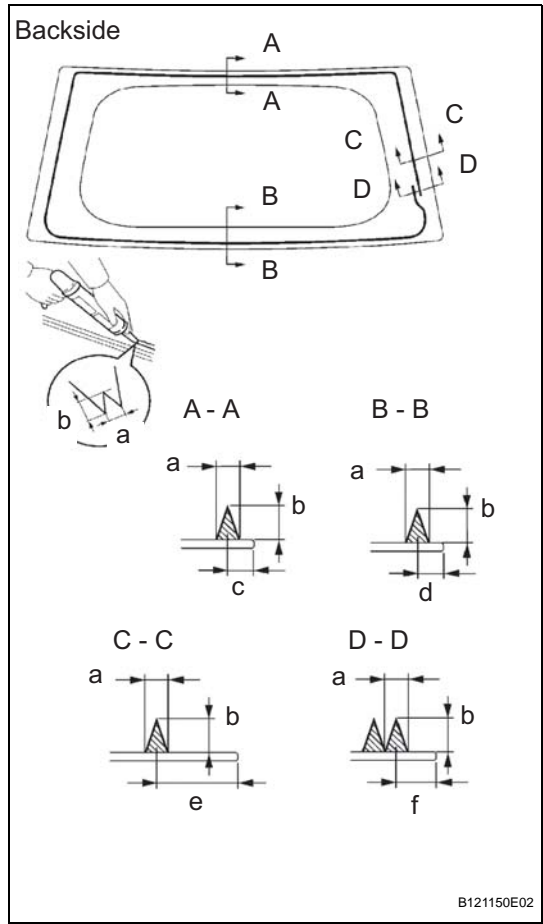

- (c) Apply adhesive to the back door glass.

Adhesive:

Part No. 08850-00801 or equivalent

- (1) Cut off the tip of the cartridge nozzle as shown in the illustration below.

HINT:

After cutting off the tip, use all adhesive within the time written in the table below.

Usage time frame

Temperature	Usage Time Frame
35°C (95°F)	15 minutes
20°C (68°F)	1 hour 40 minutes
5°C (41°F)	8 hours

- (2) Load the sealer gun with the cartridge.
(3) Apply adhesive to the back door glass as shown in the illustration.

Standard measurement

Area	Specified Condition
a	8.0 mm (0.315 in.)
b	12.5 mm (0.492 in.)
c	10.0 mm (0.394 in.)
d	12.8 mm (0.504 in.)
e	30.0 mm (1.181 in.)
f	30.0 mm (1.181 in.)

- (d) Install the back door glass to the vehicle body.
- (1) Hold the back window glass in place securely with tape or equivalent until the adhesive has hardened.

NOTICE:

- Allow the primer coating to dry for 3 minutes or more.
- Check that the clips are attached to the vehicle body correctly.
- Check the clearance between the vehicle body and glass.

- (2) Lightly press the front surface of the back door glass to ensure that the back door glass is securely fit to the vehicle body.

- (3) Using a scraper, remove any excess or protruding adhesive.

HINT:

Apply adhesive onto the glass rim.

NOTICE:

Do not drive the vehicle within the time written in the table below.

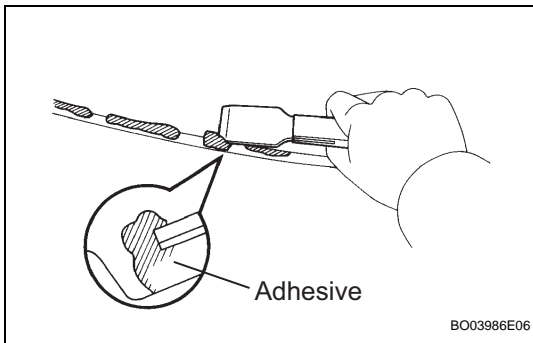
Minimum time

Temperature	Minimum time prior to driving vehicle
35°C (95°F)	1 hour 30 minutes
20°C (68°F)	5 hours
5°C (41°F)	24 hours

5. CHECK FOR LEAKS AND REPAIR

- (a) Conduct a leak test after the adhesive has completely hardened.
- (b) Seal any leaks with auto glass sealer.

6. CONNECT CABLE TO NEGATIVE BATTERY TERMINAL