



WORKSHEET 2-12 Using a Flasher Circuit

Worksheet Objectives

In this worksheet you will do the following:

- Assemble an automotive flasher (turn signal) type circuit.
- Demonstrate your knowledge of circuit operation by answering the related questions.

Tools and Equipment

For this exercise you need the following:

- Technician's Handbook
- Electrical simulator
- Digital multimeter (DMM)

Section 1: Circuit Assembly

1. Assemble the circuit shown below:

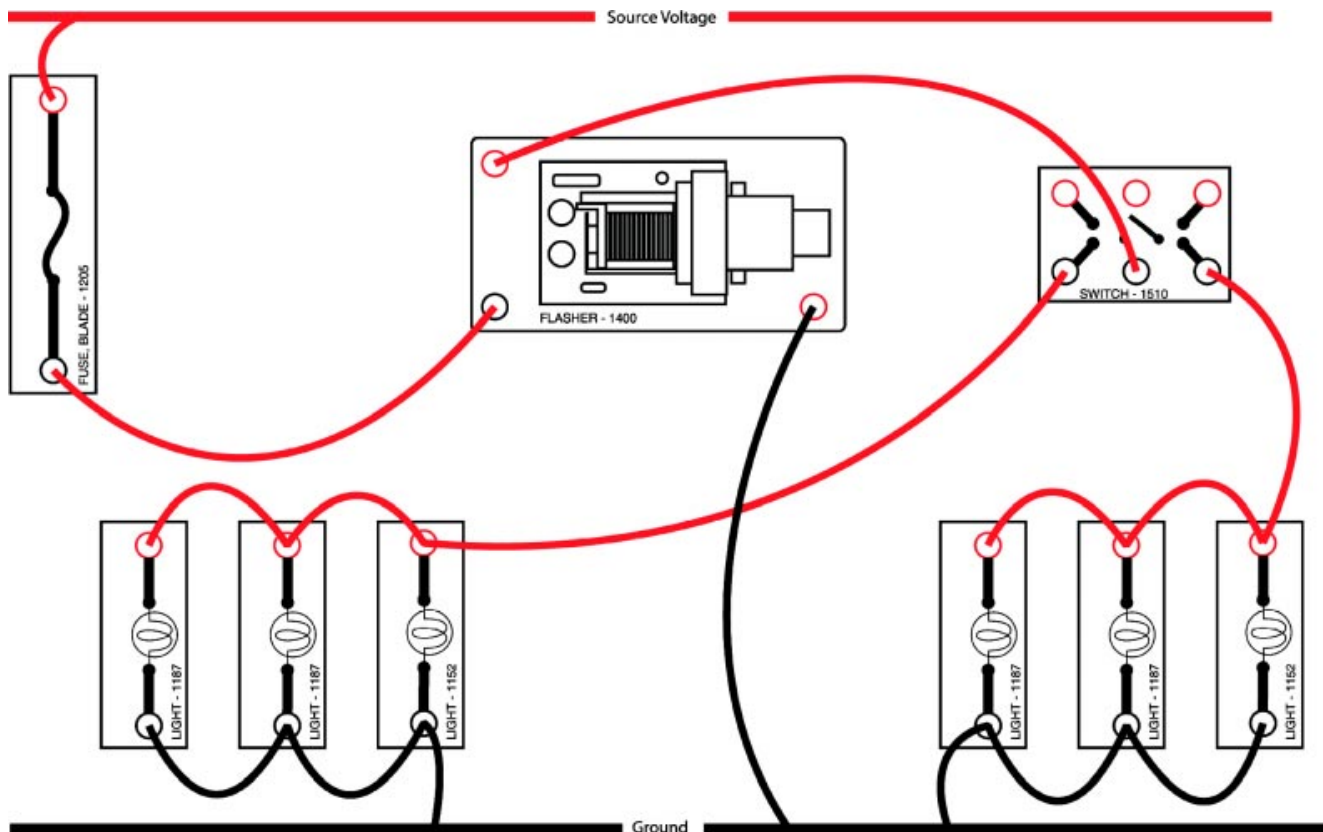

Fig. 2W12-1
TL623f001c-2W12

2. Turn on the power supply. Operate the switch. Do either set of lights flash? YES / NO (circle one).

If No, then there is not enough current draw in the circuit to operate the flasher. Add the components shown below and retry.

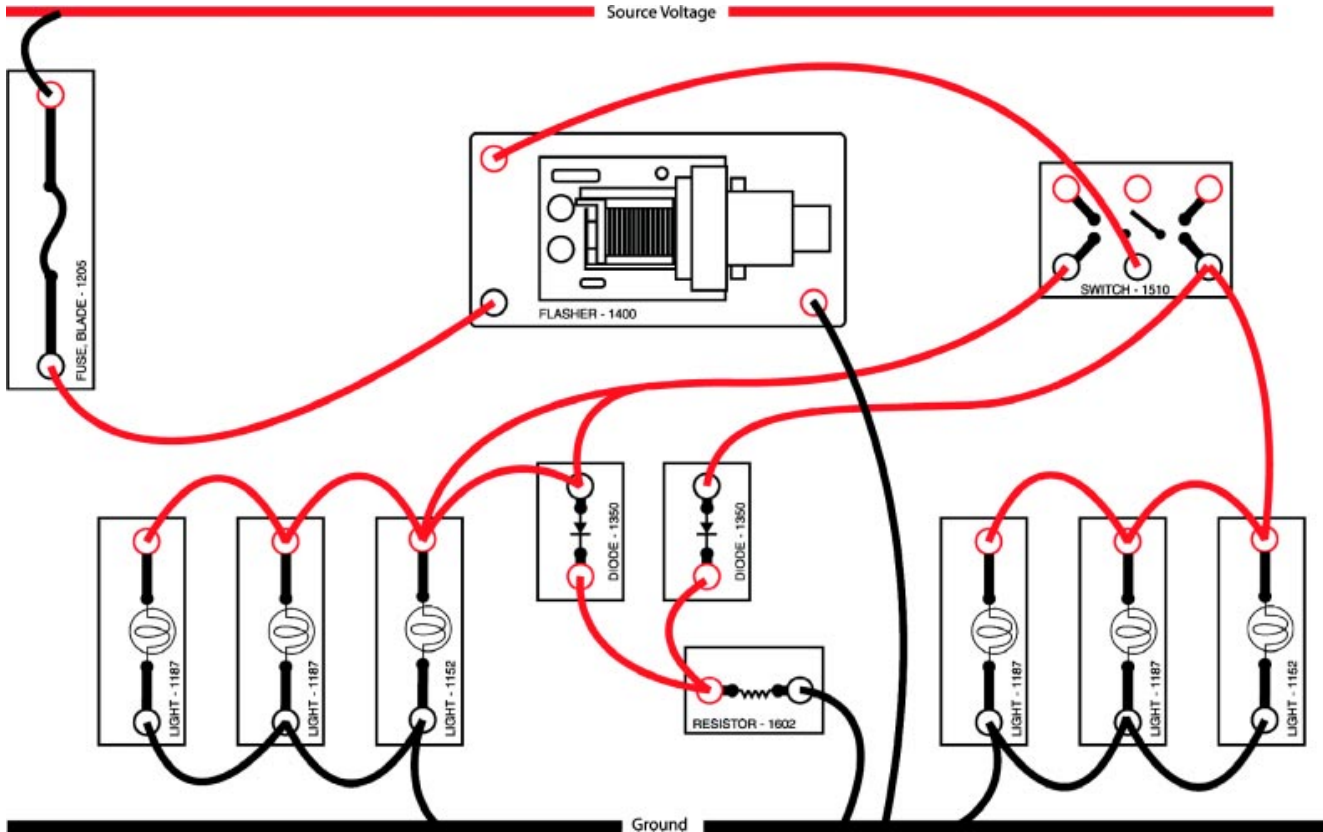

Fig. 2W12-2
TL623f002c-2W12

3. Why are the diodes required?



Stop here after completing all the related activities and answering the questions. Inform your instructor that you are ready to review this section.

Using a Flasher Circuit

Name: _____ Date: _____

Review this sheet as you are doing the Using a Flasher Circuit worksheet. Check each category after viewing the instructor’s presentation and completing the worksheet. Ask the instructor if you have questions regarding the topics provided below. Additional space is provided under topic for you to list any other concerns that you would like you instructor to address. The comments section is provided for your personal comments, information, questions, etc.

I have questions

I know I can

Topic			Comment
Circuit Function			



Notes